

**\*TM 55-8115-202-24P**

---

**TECHNICAL MANUAL**

**ORGANIZATIONAL, DIRECT,  
AND GENERAL SUPPORT MAINTENANCE  
(INCLUDING DEPOT MAINTENANCE REPAIR)  
REPAIR PARTS AND SPECIAL TOOLS LIST (RPSTL)**

**FOR**

**CONTAINER, REFRIGERATED  
MODEL SC209**

**NSN: 8115-01-016-5909**

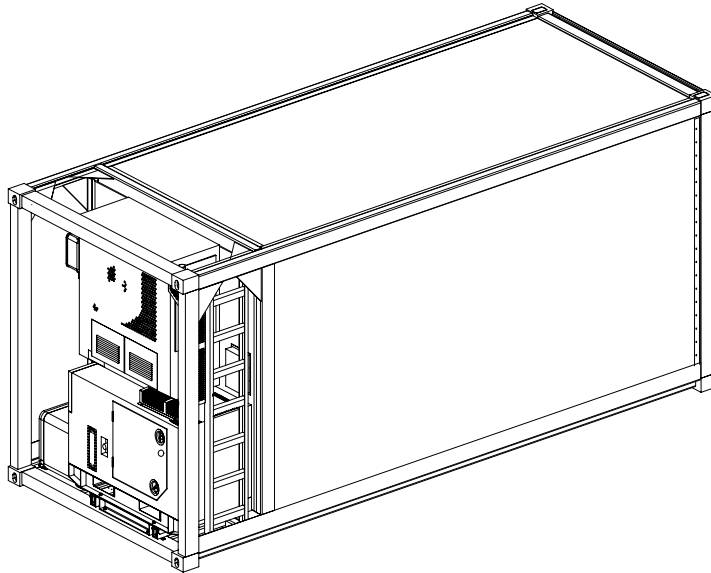

DISTRIBUTION STATEMENT A. Approved for public release; distribution is unlimited.

\*This TM supersedes TM 55-8115-202-24P, dated 29 June 1979 (Microfiche).

---

**HEADQUARTERS, DEPARTMENT OF THE ARMY**

**31 DECEMBER 2003**

THIS PAGE INTENTIONALLY LEFT BLANK

INSERT LATEST UPDATED PAGES / WORK PACKAGES DESTROY SUPERSEDED DATA

**LIST OF EFFECTIVE PAGES**

Note: The portion of text affected by the update is indicated by a vertical line in the outer margins of the page. Updates to illustrations are indicated by miniature pointing hands. Updates to wiring diagrams are indicated by shaded areas.

Dates of issue for original and updated pages / chapters are:

Original .. 0 .. 31 December 2003

**TOTAL NUMBER OF PAGES IS 14 AND TOTAL NUMBER OF WORK PACKAGES IS 18 CONSISTING OF THE FOLLOWING:**

| Page/WP No.                  | Change No. | Page/WP No. | Change No. |
|------------------------------|------------|-------------|------------|
| A/(B Blank)                  | 0          |             |            |
| i - ii                       | 0          |             |            |
| 0001 00 – 0018 00            | 0          |             |            |
| Authentication Page          | 0          |             |            |
| Electronic 2028 Instructions | 0          |             |            |
| Sample DA 2028               | 0          |             |            |
| DA 2028(s)                   | 0          |             |            |

**\*Zero in this column indicates an original page or work package**

THIS PAGE INTENTIONALLY LEFT BLANK

HEADQUARTERS  
DEPARTMENT OF THE ARMY  
WASHINGTON, D.C., 31 DECEMBER 2003

TECHNICAL MANUAL

ORGANIZATIONAL, DIRECT AND GENERAL SUPPORT MAINTENANCE  
(INCLUDING DEPOT MAINTENANCE REPAIR)  
REPAIR PARTS AND SPECIAL TOOLS LIST (RPSTL)

FOR  
CONTAINER, REFRIGERATED  
MODEL SC209

NSN 8115-01-016-5909

Current as of: 23 December 2003

**REPORTING ERRORS AND RECOMMENDING IMPROVEMENTS**

You can help improve this manual. If you find any mistakes, or if you know of a way to improve the procedures, please let us know. Mail your letter, DA Form 2028 (Recommended Changes to Publications and Blank Forms) or DA Form 2028-2 located in the back of this manual directly to: COMMANDER, U.S. Army Tank-automotive & Armament Command, ATTN: AMSTA-LC-CECT, Kansas St., Natick, MA 01760-5052. You may also submit your recommended changes by E-mail directly to: [amssbriml@natick.army.mil](mailto:amssbriml@natick.army.mil). A reply will be furnished directly to you. Instructions for sending an electronic 2028 may be found at the back of this manual immediately preceding the hard copy 2028.

**DISTRIBUTION STATEMENT A:** Approved for public release; distribution is unlimited.

\*This manual supersedes TM 55-8115-202-24P dated 29 June 1979 (Microfiche)

**TABLE OF CONTENTS**

|   | <u>WP Sequence No.</u> |
|---|------------------------|
| INTRODUCTION.....                                   | 0001 00                |
| Group 01 Document Holder and Plates.....            | 0002 00                |
| Group 02 Door and Hardware .....                    |                        |
| Door Assembly and Hardware, Right .....             | 0003 00                |
| Door Assembly and Hardware, Left .....              | 0004 00                |
| Group 03 Frame Members, Secondary .....             |                        |
| Container Assembly and Hardware.....                | 0005 00                |
| Repair Panels and Materials .....                   | 0006 00                |
| Group 04 Thermometer Assembly .....                 | 0007 00                |
| Group 05 Fuel Tank Assembly .....                   | 0008 00                |
| Group 06 Exhaust Shield and Pipes.....              | 0009 00                |
| Group 07 Electrical Equipment and Spacers .....     |                        |
| Light Assembly and Power Cable Assembly .....       | 0010 00                |
| Air Flow Spacers and Button Plugs .....             | 0011 00                |
| Group 08 Refrigeration Unit.....                    | 0012 00                |
| Group 09 Generator Set and Mounting Hardware .....  | 0013 00                |
| Group 10 Slide Assembly and Mounting Hardware ..... | 0014 00                |
| Group 11 Bulk Items List .....                      | 0015 00                |

|                                   | <u>WP Sequence No.</u> |
|-----------------------------------|------------------------|
| SPECIAL TOOLS LIST .....          | 0016 00                |
| National Stock Number Index ..... | 0017 00                |
| Part Number Index .....           | 0018 00                |

**ORGANIZATIONAL, DIRECT, AND GENERAL SUPPORT MAINTENANCE  
(INCLUDING DEPOT MAINTENANCE REPAIR)**

**CONTAINER, REFRIGERATED**

**MODEL SC209, NSN: 8115-01-016-5909**

## INTRODUCTION

### SCOPE

This RPSTL lists and authorizes spares and repair parts; special tools; special test, measurement, and diagnostic equipment (TMDE); and other special support equipment required for performance of operator, direct, and general support maintenance of the Container, Refrigerated Model SC209. It authorizes the requisitioning, issue, and disposition of spares, repair parts, and special tools as indicated by the source, maintenance, and recoverability (SMR) codes.

### GENERAL

In addition to the Introduction work package, this RPSTL is divided into the following work packages.

1. Repair Parts List Work Packages. Work packages containing lists of spares and repair parts authorized by this RPSTL for use in the performance of maintenance. These work packages also include parts that must be removed for replacement of the authorized parts. Parts lists are composed of functional groups in ascending alphanumeric sequence, with the parts in each group listed in ascending figure and item number sequence. Sending units, brackets, filters, and bolts are listed with the component they mount on. Bulk materials are listed by item name in FIG. BULK at the end of the work packages. Repair parts kits are listed separately in their own functional group and work package. Repair parts for repairable special tools are also listed in a separate work package. Items listed are shown on the associated illustrations.

2. Special Tools List Work Packages. Work packages containing lists of special tools, special TMDE, and special support equipment authorized by this RPSTL (as indicated by Basis of Issue (BOI) information in the DESCRIPTION AND USABLE ON CODE (UOQ column). Tools that are components of common tool sets and/or Class VII are not listed.

3. Cross-Reference Indexes Work Packages. There are three cross-reference indexes work packages in this RPSTL: the National Stock Number (NSN) Index work package, the Part Number (P/N) Index work package, and the Reference Designator Index work package. The NSN Index workpackage refers you to the figure and item number. The PIN work package refers you to the figure and item number. The Reference Designator Index work package refers you to the figure and item number)

### EXPLANATION OF COLUMNS IN THE REPAIR PARTS LIST AND SPECIAL TOOLS LIST WORK PACKAGES

ITEM NO. (Column (1)). Indicates the number used to identify items called out in the illustration.

SMR CODE. (Column (2)). The SMR code containing supply/requisitioning information, maintenance level authorization criteria, and disposition instruction, as shown in the following breakout::

| <u>Source Code</u>  | <u>Maintenance Code</u>  | <u>Recoverability Code</u>                                      |
|---|--|---|
| <u>XX</u>   | <u>XX</u>  | <u>X</u>  |
| 1st two 3rd position:<br>positions:<br>How to get an<br>item. | 4th position:<br>Who can install<br>replace, or use<br>the item. | 5th position:<br>Who can do<br>complete repair*<br>on the item. |
|   |  | Who determines<br>disposition action on<br>unserviceable items. |

\*Complete Repair: Maintenance capacity, capability, and authority to perform all corrective maintenance tasks of the "Repair" function in a use/user environment in order to restore serviceability to a failed item.

Source Code. The source code tells you how you get an item needed for maintenance, repair, or overhaul of an end item/equipment. Explanations of source codes follow:

**SOURCE CODE****Application/Explanation**

PA  
PB  
PC  
PD  
PE  
PF  
PG

Stock items; use the applicable NSN to requisition/request items with these source codes. They are authorized to the level indicated by the code entered in the 3<sup>rd</sup> position of the SMR code.

**NOTE**

**Items coded PC are subject to deterioration.**

KD  
KF  
KB

Items with these codes are not to be requested/requisitioned individually. They are part of a kit that is authorized to the maintenance level indicated in the 3<sup>rd</sup> position of the SMR code. The complete kit must be requisitioned and applied.

MO – (Made at unit/AVUM Level)  
MF – (Made at DS/AVIM Level)  
MH – (Made at GS Level)  
ML – (Made at SRA)  
MD – (Made at Depot)

Items with these codes are not to be requisitioned/requested individually. They must be made from bulk material that is identified by the P/N in the DESCRIPTION and USABLE ON CODE (UOC) column and listed in the bulk material group work package of the RPSTL. If the item is authorized to you by the 3<sup>rd</sup> position code of the SMR code, but the source code indicates it is made at a higher level, order the item from the higher level of maintenance.

AO – (Assembled by unit AVUM Level)  
AF – (Assembled by DS/AVIM Level)  
AH – (Assembled by GS Level)  
AL – (Assembled by SRA)  
AD – (Assembled by Depot)

Items with these codes are not to be requested/requisitioned individually. The parts that make up the assembled item must be requisitioned or fabricated and assembled at the level of maintenance indicated by the source code. If the 3<sup>rd</sup> position code of the SMR code authorizes you to replace the item, but the source code indicates the item is assembled at a higher level, order the item from the higher level of maintenance.

XA -

Do not requisition an XA-coded item. Order the next higher assembly. (Refer to the NOTE below.)

XB -

If an item is not available from salvage, order it using the CAGEC and P/N.

XC -

Installation drawings, diagrams, instruction sheets, field service drawings; identified by manufacturer's P/N.

XD -

Item is not stocked. Order an XD-coded item through normal supply channels using the CAGEC and P/N given, if no NSN is available.

**NOTE**

Cannibalization or controlled exchange, when authorized, may be used as a source of supply for items with the above source codes except for those items source coded "XA" or those aircraft support items restricted by requirements of AR 750- 1.



Maintenance Code. Maintenance codes tell you the levels of maintenance authorized to use and repair support items. The maintenance codes are entered in the third and fourth positions of the SMR code as follows:

Third Position. The maintenance code entered in the third position tells you the lowest maintenance level authorized to remove, replace, and use an item. The maintenance code entered in the third position will indicate authorization to the following levels of maintenance:

**Maintenance  
Code**

**Application/Explanation**

- C --- Crew or operator maintenance done within unit/AVUM maintenance.
- O --- Unit level/AVUM maintenance can remove, replace, and use the item.
- F --- Direct support/AVIM maintenance can remove, replace, and use the item.
- H --- General support maintenance can remove, replace, and use the item.
- L --- Specialized repair activity can remove, replace, and use the item.
- D --- Depot can remove, replace, and use the item.

Fourth Position. The maintenance code entered in the fourth position tells you whether or not the item is to be repaired and identifies the lowest maintenance level with the capability to do complete repair (perform all authorized repair functions).

**NOTE**

Some limited repair may be done on the item at a lower level of maintenance, if authorized by the Maintenance Allocation Chart (MAC) and SMR codes.

**Maintenance  
Code**

**Application/Explanation**

- O --- Unit/AVUM is the lowest level that can do complete repair of the item.
- F --- Direct support/AVIM is the lowest level that can do complete repair of the item.
- H --- General support is the lowest level that can do complete repair of the item.
- L --- Specialized repair activity (enter specialized repair activity designator) is the lowest level that can do complete repair of the item.
- D --- Depot is the lowest level that can do complete repair of the item.
- Z --- Nonreparable. No repair is authorized.
- B --- No repair is authorized. No parts or special tools are authorized for maintenance of "B" coded item. However, the item may be reconditioned by adjusting, lubricating, etc., at the user level.

Recoverability Code. Recoverability codes are assigned to items to indicate the disposition action on unserviceable items. The recoverability code is shown in the fifth position of the SMR code as follows:

**Recoverability  
Code**

**Application/Explanation**

|       |   |
|-------|---|
| Z --- | Nonreparable item. When unserviceable, condemn and dispose of the item at the level of maintenance shown in the third position of the SMR code.   |
| O --- | Reparable item. When uneconomically reparable, condemn and dispose of the item at the unit level.   |
| F --- | Reparable item. When uneconomically reparable, condemn and dispose of the item at the direct support level.   |
| H --- | Reparable item. When uneconomically reparable, condemn and dispose of the item at the general support level.  |
| D --- | Reparable item. When beyond lower level repair capability, return to depot. Condemnation and disposal of item are not authorized below depot level.   |
| L --- | Reparable item. Condemnation and disposal not authorized below Specialized Repair Activity (SRA).   |
| A --- | Item requires special handling or condemnation procedures because of specific reasons (such as precious metal content, high dollar value, critical material, or hazardous material). Refer to appropriate Manuals/directives for specific instructions. |

NSN (Column (3)). The NSN for the item is listed in this column.

CAGEC (Column (4)). The Commercial and Government Entity Code (CAGEC) is a five-digit code that is used to identify the manufacturer, distributor, or Government agency/activity that supplies the item.

PART NUMBER (Column (5)). Indicates the primary number used by the manufacturer (individual, company, firm, corporation, or Government activity), which controls the design and characteristics of the item by means of its engineering drawings, specifications, standards, and inspection requirements to identify an item or range of items.

**NOTE**

When you use an NSN to requisition an item, the item you receive may have a different PIN from the number listed.

DESCRIPTION AND USABLE ON CODE (UOQ (Column (6))). This column includes the following information:

1. The federal item name, and when required, a minimum description to identify the item.
2. P/Ns of bulk materials are referenced in this column in the line entry to be manufactured or fabricated.
3. Hardness Critical Item (HCI). A support item that provides the equipment with special protection from electromagnetic pulse (EMP) damage during a nuclear attack.
4. The statement END OF FIGURE appears just below the last item description in column (6) for a given figure in both the repair parts list and special tools list work packages.

QTY (Column (7)). The QTY (quantity per figure) column indicates the quantity of the item used in the breakout shown on the illustration/figure, which is prepared for a functional group, subfunctional group, or an assembly. A "V" appearing in this column instead of a quantity indicates that the quantity is variable and quantity may change from application to application.

## EXPLANATION OF CROSS-REFERENCE INDEXES WORK PACKAGES FORMAT AND COLUMNS

### I. National Stock Number (NSN) Index Work Package.

**STOCK NUMBER Column.** This column lists the NSN in national item identification number (NIIN) sequence. The NIIN consists of the last nine digits of the NSN.

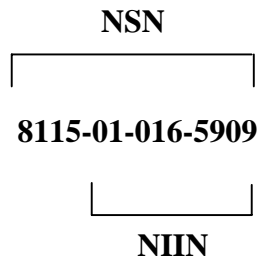

When using this column to locate an item, ignore the first 4 digits of the NSN. However, the complete NSN should be used when ordering items by stock number.

**FIG. Column.** This column lists the number of the figure where the item is identified/located. The figures are in numerical order in the repair parts list and special tools list work packages.

**ITEM Column.** The item number identifies the item associated with the figure listed in the adjacent FIG. column. This item is also identified by the NSN listed on the same line.

**2. Part Number (P/N) Index Work Package.** P/Ns in this index are listed in ascending alphanumeric sequence (vertical arrangement of letter and number combinations that places the first letter or digit of each group in order A through Z, followed by the numbers 0 through 9 and each following letter or digit in like order).

**PART NUMBER Column.** Indicates the P/N assigned to the item.

**FIG. Column.** This column lists the number of the figure where the item is identified/located in the repair parts list and special tools list work packages.

**ITEM Column.** The item number is the number assigned to the item as it appears in the figure referenced in the adjacent figure number column."

## SPECIAL INFORMATION

**Fabrication Instructions.** Bulk materials required to manufacture items are listed in the bulk material functional group of this RPSTL. Part numbers for bulk material are also referenced in the Description Column of the line item entry for the item to be manufactured/fabricated. Detailed fabrication instructions for items source coded to be manufactured or fabricated are found in TM 55-8115-202-14

**Index Numbers.** Items which have the word BULK in the figure column will have an index number shown in the item number column. This index number is a cross-reference between the NSN / P/N index work packages and the bulk material list in the repair parts list work package."

Associated Publications. The publication listed below pertains to the Container, Refrigerated Model SC209:

TM 55-8115-202-14 Operator's, Organizational, Direct and General Support (Including Depot Maintenance) Repair Manual for Container, Refrigerated Model SC209

## HOW TO LOCATE REPAIR PARTS

### 1. When NSNs or P/Ns Are Not Known.

First. Using the table of contents, determine the assembly group to which the item belongs. This is necessary since figures are prepared for assembly groups and subassembly groups, and lists are divided into the same groups.

Second. Find the figure covering the functional group or the subfunctional group to which the item belongs.

Third. Identify the item on the figure and note the number(s).

Fourth. Look in the repair parts list work packages for the figure and item numbers. The NSNs and part numbers are on the same line as the associated item numbers.

### 2. When NSN Is Known.

First. If you have the NSN, look in the STOCK NUMBER column of the NSN index work package. The NSN is arranged in NIIN sequence. Note the figure and item number next to the NSN.

Second. Turn to the figure and locate the item number. Verify that the item is the one you are looking for.

### 3. When P/N Is Known.

First. If you have the P/N and not the NSN, look in the PART NUMBER column of the P/N index work package. Identify the figure and item number.

Second. Look up the item on the figure in the applicable repair parts list work package."

## ABBREVIATIONS

### Abbreviation

### Explanation

### NOTE

Include uncommon abbreviations used in the RPSTL. List1define those not found in ASME Y14.38.

**END OF WORK PACKAGE**

THIS PAGE INTENTIONALLY LEFT BLANK

ORGANIZATIONAL, DIRECT, AND GENERAL SUPPORT MAINTENANCE  
(INCLUDING DEPOT MAINTENANCE REPAIR)

CONTAINER, REFRIGERATED  
MODEL SC209, NSN: 8115-01-016-5909

DOCUMENT HOLDER AND PLATES

REPAIR PARTS LIST

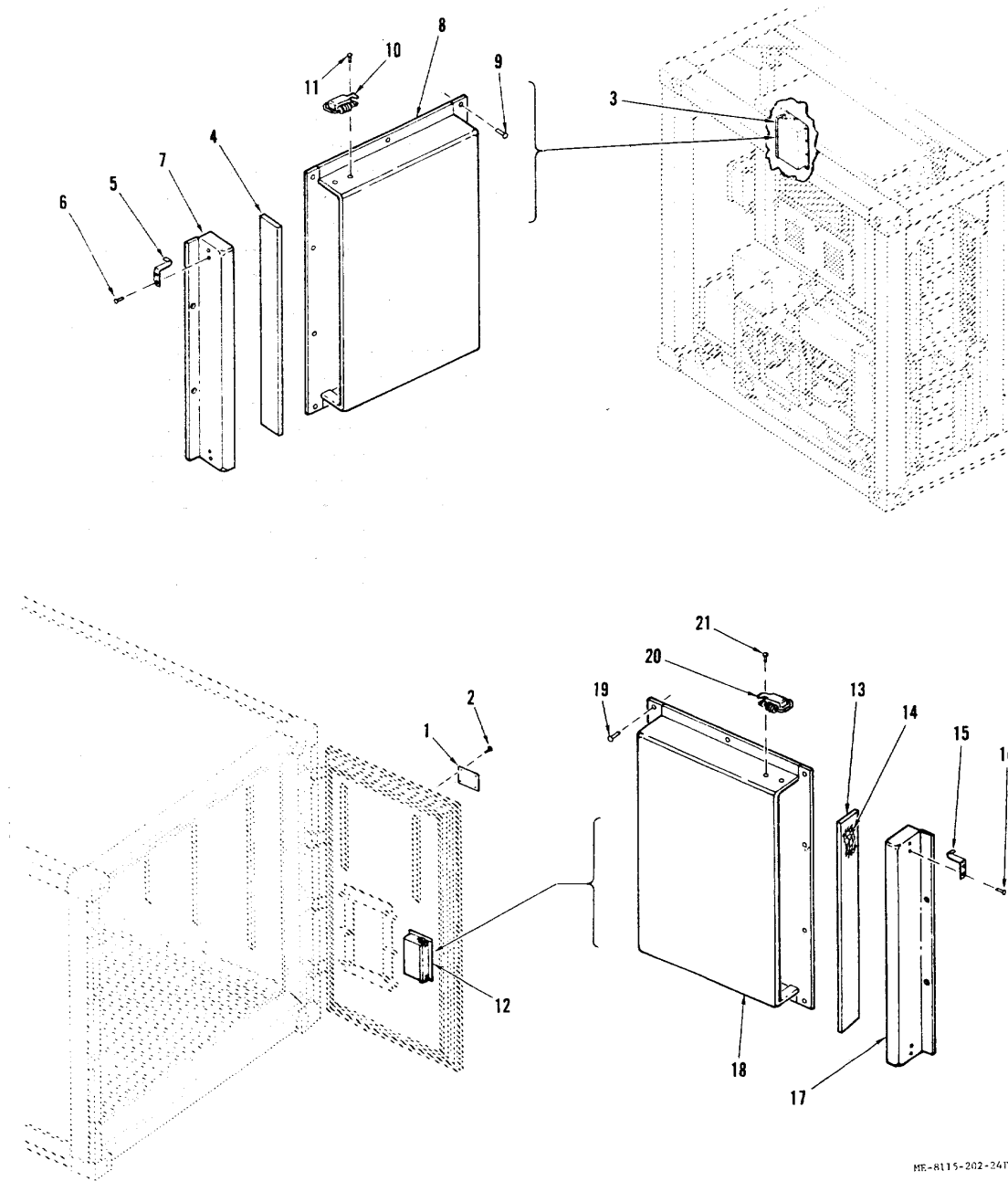

MR-8115-202-24P/1

Figure 1. Document and Manual Boxes, and Identification Plate

| (1)<br>ITEM<br>NO. | (2)<br>SMR<br>CODE | (3)<br>NSN       | (4)<br>CAGEC | (5)<br>PART NUMBER | (6)<br>DESCRIPTION AND USABLE ON<br>CODE (UOC)                    | (7)<br>QTY |
|--------------------|--------------------|------------------|--------------|--------------------|---|------------|
|                    |                    |                  |              |                    | GROUP 01 DOCUMENT HOLDER<br>AND PLATES                            |            |
|                    |                    |                  |              |                    | FIG. 1 DOCUMENT AND MANUAL<br>BOXES, AND IDENTIFICATION<br>PLATES |            |
| 1                  | XBOZZ              |                  | 90598        | 30439-1            | PLATE, IDENT.....   | 1          |
| 2                  | PAOZZ              |                  | 94222        | 38-104-09-93       | RIVET, DRIVE.....   | 4          |
| 3                  | XBOOZ              |                  | 90598        | 30408-100          | COVER, ASSY.....  | 1          |
| 4                  | PAOZZ              | 5330-01-C74-1355 | 86730        | 4111D1/8X3         | .GASKET.....  | V          |
| 5                  | PAOZZ              |                  | 98003        | SC-D-20650-14      | .LATCH, HOOK.....   | 2          |
| 6                  | PAOZZ              |                  | 07707        | AD428SH            | .RIVET, BLIND.....  | 4          |
| 7                  | PAOZZ              |                  | 90598        | 30408-1            | .COVER.....   | 1          |
| 8                  | XBOOZ              |                  | 90598        | 30407-100          | BOX AY.....   | 1          |
| 9                  | PAOZZ              | 5320-01-074-2133 | 94222        | 38-104-12-93       | RIVEET, DRIVE.....  | 10         |
| 10                 | PAOZZ              | 5340-00-860-3862 | 98003        | SCD020648          | .CATCH, LOOP.....   | 2          |
| 11                 | PAOZZ              |                  | 07707        | AD42BSH            | .RIVET, BLIND.....  | 1          |
| 12                 | XBOOZ              |                  | 90598        | 30405-100          | COVER ASSY.....   | 1          |
| 13                 | PAOZZ              | 5330-01-074-1998 | 86730        | 4111D1/8X2         | .GASKET.....  | 1          |
| 14                 | PAOZZ              |                  | 04963        | 1357               | .ADHESIVE.....  | V          |
| 15                 | PAOZZ              |                  | 98003        | SC-D-20650-14      | .LATCH, HOOK.....   | 2          |
| 16                 | PAOZZ              |                  | 07707        | AD42BSH            | .RIVET, BLIND.....  | 4          |
| 17                 | PAOZZ              |                  | 90598        | 30405-1            | .COVER.....   | 1          |
| 18                 | XBOOZ              |                  | 90598        | 30404-100          | BOX ASSY.....   | 1          |
| 19                 | PAOZZ              | 5320-00-846-3852 | 07707        | AD44BS             | RIVET, BLIND.....   | 10         |
| 20                 | PAOZZ              | 5340-00-860-3862 | 98003        | SC-D20648          | .CATCH, LOOP.....   | 2          |
| 21                 | PAOZZ              |                  | 07707        | AD42BSH            | .RIVET, BLIND.....  | 4          |
|                    |                    |                  |              |                    | END OF FIGURE   |            |

THIS PAGE INTENTIONALLY LEFT BLANK



THIS PAGE INTENTIONALLY LEFT BLANK

ORGANIZATIONAL, DIRECT, AND GENERAL SUPPORT MAINTENANCE  
(INCLUDING DEPOT MAINTENANCE REPAIR)

CONTAINER, REFRIGERATED  
MODEL SC209, NSN: 8115-01-016-5909

DOOR AND HARDWARE

REPAIR PARTS LIST

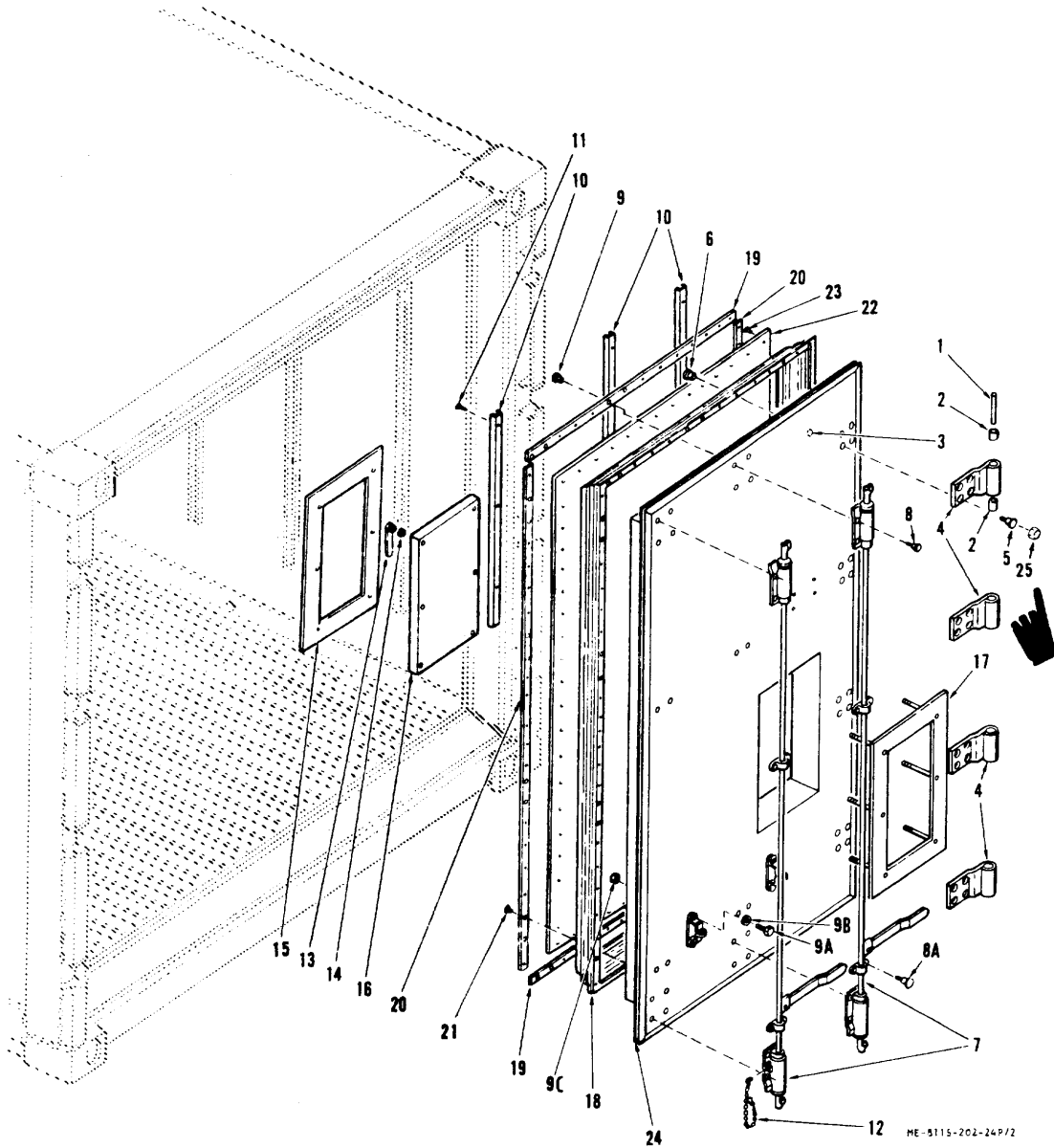

Figure 2. Door Assembly and Hardware, Right

| (1)<br>ITEM<br>NO.                          | (2)<br>SMR<br>CODE | (3)<br>NSN       | (4)<br>CAGEC | (5)<br>PART NUMBER | (6)<br>DESCRIPTION AND USABLE ON<br>CODE (UOC)                                  | (7)<br>QTY |
|---|--------------------|------------------|--------------|--------------------|---|------------|
| GROUP 02 DOOR AND HARDWARE                  |                    |                  |              |                    |   |            |
| FIG. 2 DOOR ASSEMBLY AND<br>HARDWARE, RIGHT |                    |                  |              |                    |   |            |
| 1   | PAOZZ              |                  | 76368        | HP1054-3           | .HINGE PIN.....   | 8          |
| 2   | PAOZZ              |                  | 76368        | BU1062-1           | BUSHING, SLEEVE.....  | 16         |
| 3   | XBOOZ              |                  | 90598        | 30375-100          | DOOR ASSY., RIGHT.....  | 1          |
| 4   | PAOZZ              |                  | 76368        | H1060-4            | .HINGE, STRAP.....  | 4          |
| 5   | PAOZZ              |                  | 93907        | 821-84160          | .BOLT, CAMTAINER.....   | 16         |
| 6   | PAOZZ              |                  | 93907        | 890-60008          | .NUT, CAMTAINER.....  | 16         |
| 7   | PAOZZ              |                  | 76368        | DL1104             | .LOCKING BAR.....   | 2          |
| 8   | PAOZZ              |                  | 93907        | 821-84160          | .BOLT, CAMTAINER.....   | 18         |
| 8A  | PAOZZ              |                  | 93907        | 821-82920          | .BOLT, CAMTAINER.....   | 8          |
| 9   | PAOZZ              |                  | 93907        | 890-60008          | .NUT, CAMTAINER.....  | 26         |
| 9A  | PAOZZ              | 5305-00-269-3216 | 93906        | MS90725-66         | .SCREW, CAP.....  | 2          |
| 9B  | PAOZZ              | 5310-00-080-6004 | 93906        | MS27183-14         | .WASHER, FLAT.....  | 4          |
| 9C  | PAOZZ              | 5310-00-087-4652 | 93906        | MS51922-17         | .NUT, SELF-LOCK.....  | 2          |
| 10  | PAOZZ              | 5365-01-074-1889 | 90598        | 30438-3            | .SPACER.....  | 3          |
| 11  | PAOZZ              | 5320-00-850-3264 | 07707        | AD68BS             | .RIVET, BLIND.....  | 6          |
| 12  | PAOZZ              | 4010-01-074-2004 | 90598        | 30436-100          | .CHAIN ASSY.....  | 1          |
| 13  | PAOZZ              |                  | 90598        | 30357-100          | .HANDLE, DOOR.....  | 6          |
| 14  | PAOZZ              | 5310-00-945-0528 | 96906        | MS9321-11          | .WASHER, FLAT.....  | 6          |
| 15  | PBOZZ              |                  | 90598        | 30356-100          | .FRAME, DOOR.....   | 1          |
| 16  | XDOZZ              |                  | 90598        | 30355-100          | .DOOR, ESCAPE.....  | 1          |
| 17  | PBOZZ              | 8115-01-066-6054 | 90598        | 30356-101          | .FRAME, DOOR.....   | 1          |
| 18  | PAOZZ              | 5330-01-074-3530 | 90598        | 30385-1            | .SEAL, DOOR, RIGHT.....   | 1          |
| 19  | PAOZZ              |                  | 90598        | 30387-1            | .METAL STRIP ALUMINUM: ¾ IN.<br>WIDE, 1/16 IN> THICK, 42 ¼ IN.<br>LONG.....     | 2          |
| 20  | PAOZZ              |                  | 90598        | 30388-1            | .METAL STRIP ALUMINUM: ¾ IN.<br>WIDE, 1/16 IN> THICK, 6 FT 8 ¾ IN.<br>LONG..... | 2          |

| (1)<br>ITEM<br>NO. | (2)<br>SMR<br>CODE | (3)<br>NSN       | (4)<br>CAGEC | (5)<br>PART NUMBER | (6)<br>DESCRIPTION AND USABLE ON<br>CODE (UOC) | (7)<br>QTY |
|--------------------|--------------------|------------------|--------------|--------------------|--|------------|
|                    |                    |                  |              |                    | GROUP 02 DOOR AND HARDWARE                     |            |
|                    |                    |                  |              |                    | FIG. 2 DOOR ASSEMBLY AND<br>HARDWARE, RIGHT    |            |
| 21                 | PAOZZ              | 5320-00-846-3852 | 07707        | AD44BS             | .RIVET.....                                    | 62         |
| 22                 | PAOOZ              |                  | 90598        | 30373-1            | .SHEET, FIBERGLASS.....                        | 1          |
| 23                 | PAOZZ              | 5320-00-846-3852 | 07707        | AD44BS             | .RIVET, BLIND.....                             | 58         |
| 24                 | PAOZZ              | 5330-01-074-1891 | 08048        | 58R16-12           | .SEAL, EXTRUSION.....                          | 1          |
| 25                 | PAOZZ              | 5340-00-689-7213 | 19207        | 7529296            | .BUMPER, RUBBER.....                           | 2          |
|                    |                    |                  |              |                    | END OF FIGURE                                  |            |

THIS PAGE INTENTIONALLY LEFT BLANK

ORGANIZATIONAL, DIRECT, AND GENERAL SUPPORT MAINTENANCE  
(INCLUDING DEPOT MAINTENANCE REPAIR)

CONTAINER, REFRIGERATED  
MODEL SC209, NSN: 8115-01-016-5909

DOOR AND HARDWARE

REPAIR PARTS LIST

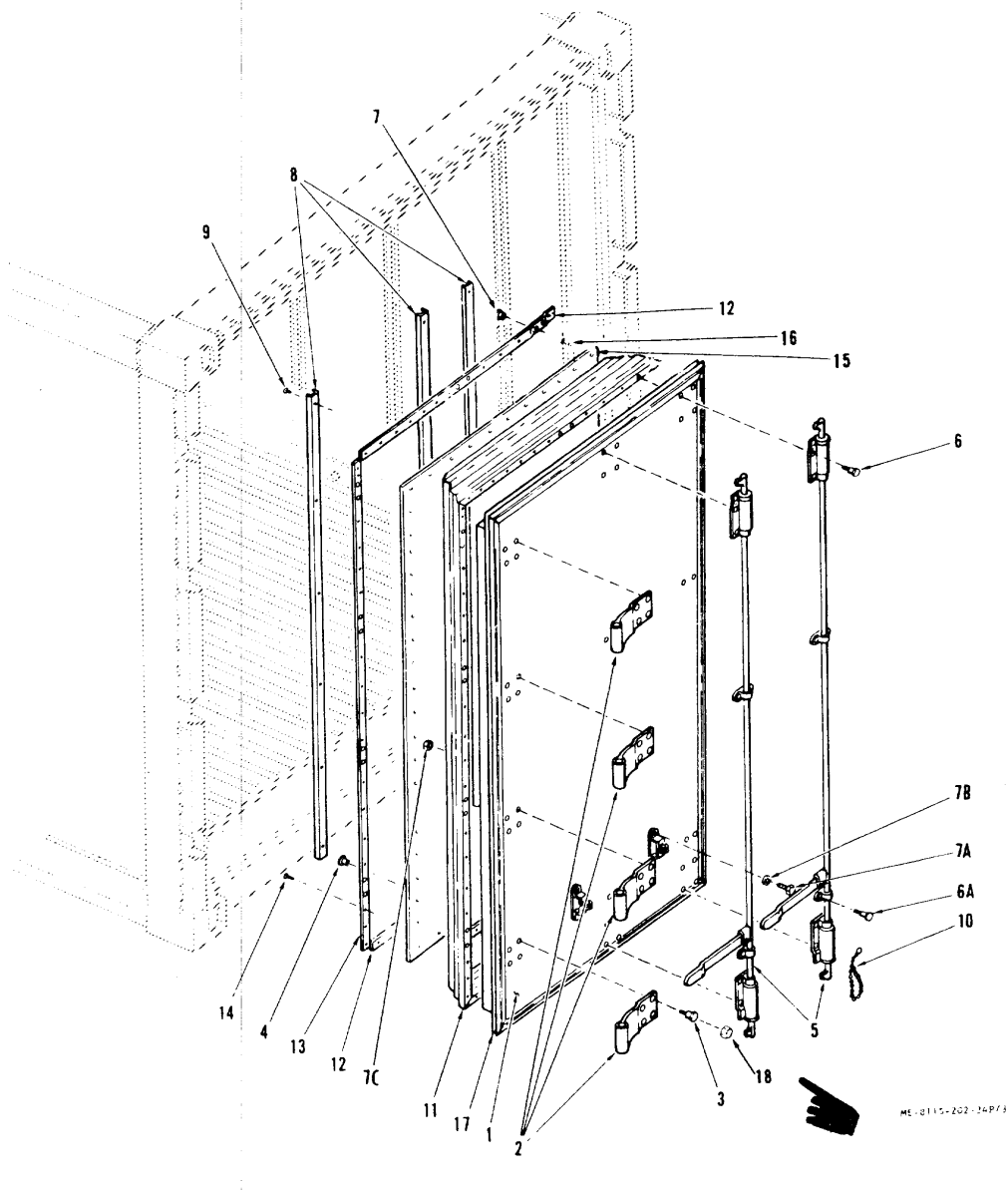

Figure 3. Door Assembly and Hardware, Left

| (1)<br>ITEM<br>NO.                         | (2)<br>SMR<br>CODE | (3)<br>NSN       | (4)<br>CAGEC | (5)<br>PART NUMBER | (6)<br>DESCRIPTION AND USABLE ON<br>CODE (UOC)                                   | (7)<br>QTY |
|--|--------------------|------------------|--------------|--------------------|--|------------|
| GROUP 02 DOOR AND HARDWARE                 |                    |                  |              |                    |  |            |
| FIG. 3 DOOR ASSEMBLY AND<br>HARDWARE, LEFT |                    |                  |              |                    |  |            |
| 1  | XBOOZ              |                  | 90598        | 30376-100          | DOOR ASSY., LEFT.....  | 1          |
| 2  | PAOZZ              |                  | 76368        | H1060-4            | .HINGE, STRAP.....   | 4          |
| 3  | PAOZZ              |                  | 93907        | 821-84160          | .BOLT, CAMTAINER.....  | 16         |
| 4  | PAOZZ              |                  | 93907        | 890-60008          | .NUT, CAMTAINER.....   | 16         |
| 5  | PAOZZ              |                  | 76368        | DL1104             | .LOCKING BAR.....  | 2          |
| 6  | PAOZZ              |                  | 93907        | 821-84160          | .BOLT, CAMTAINER.....  | 24         |
| 6A   | PAOZZ              |                  | 93907        | 821-82920          | .BOLT, CAMTAINER.....  | 8          |
| 7  | PAOZZ              |                  | 93907        | 890-60008          | .NUT, CAMTAINER.....   | 24         |
| 7A   | PAOZZ              | 5305-00-269-3216 | 96906        | MS90725-66         | .SCREW, CAP.....   | 2          |
| 7B   | PAOZZ              | 5310-00-080-6004 | 96906        | MS27183-14         | .WASHER, FLAT.....   | 4          |
| 7C   | PAOZZ              | 5310-00-087-4652 | 96906        | MS51922-17         | .NUT, SELF-LOCK.....   | 2          |
| 8  | PAOZZ              | 5365-01-074-1887 | 90598        | 30438-1            | .SPACER.....   | 3          |
| 9  | PAOZZ              | 5320-00-850-3264 | 07707        | AD68BS             | .RIVET, BLIND.....   | 18         |
| 10   | PAOZZ              | 4010-01-074-2004 | 90598        | 30436-100          | .CHAIN ASSY.....   | 1          |
| 11   | PAOZZ              | 5330-01-074-1890 | 90598        | 30386-1            | .SEAL, DOOR, LEFT.....   | 1          |
| 12   | PAOZZ              |                  | 90598        | 30391-1            | .METAL STRIP ALUMINUM: ¾ IN.<br>WIDE, 1/16 IN. THICK, 42 ¼ IN.<br>LONG.....      | 2          |
| 13   | PAOZZ              |                  | 90598        | 30388-1            | .METAL STRIP ALUMINUM: ¾ IN.<br>WIDE, 1/16 IN. THICK, 6 FT. 8 ¾ IN.<br>LONG..... | 1          |
| 14   | PAOZZ              | 5320-00-846-3852 | 07707        | AD44BS             | .RIVET, BLIND.....   | 45         |
| 15   | PAOZZ              |                  | 90598        | 30374-1            | .SHEET, FIBERGLASS.....  | 1          |
| 16   | PAOZZ              | 5320-00-846-3852 | 07707        | AD44BS             | .RIVET, BLIND.....   | 43         |
| 17   | PAOZZ              | 5330-01-074-1891 | 08048        | 58R-16-12          | .SEAL, EXTRUSION.....  | V          |
| 18   | PAOZZ              | 5340-00-689-7213 | 19207        | 7529296            | BUMPER, RUBBER.....  | 2          |
| END OF FIGURE                              |                    |                  |              |                    |  |            |

THIS PAGE INTENTIONALLY LEFT BLANK



THIS PAGE INTENTIONALLY LEFT BLANK

ORGANIZATIONAL, DIRECT, AND GENERAL SUPPORT MAINTENANCE  
(INCLUDING DEPOT MAINTENANCE REPAIR)

CONTAINER, REFRIGERATED  
MODEL SC209, NSN: 8115-01-016-5909

FRAME MEMBERS, SECONDARY

REPAIR PARTS LIST

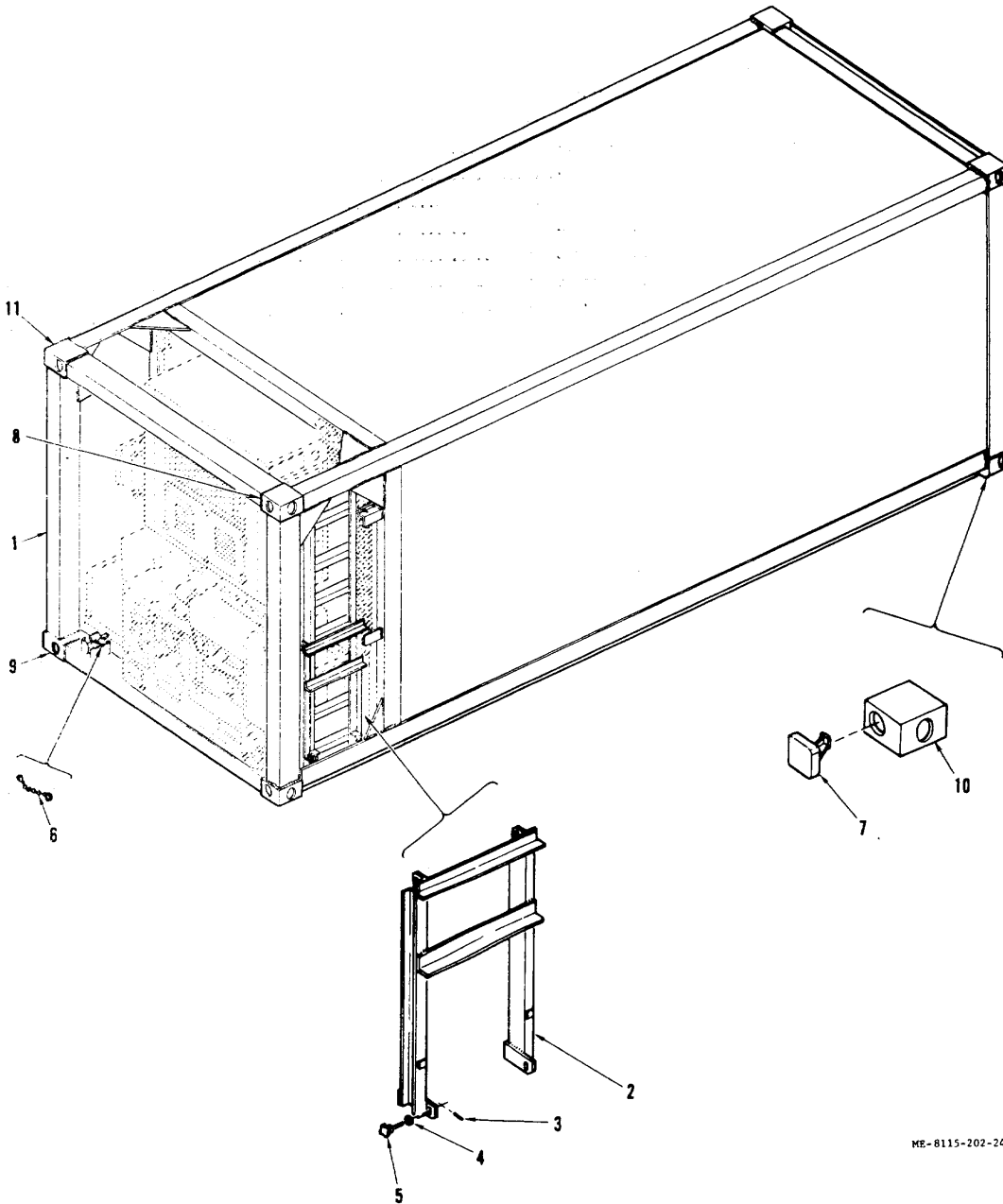

ME-8115-202-24P/4

Figure 4. Container Assembly and Hardware

| (1)<br>ITEM<br>NO. | (2)<br>SMR<br>CODE | (3)<br>NSN       | (4)<br>CAGEC | (5)<br>PART NUMBER | (6)<br>DESCRIPTION AND USABLE ON<br>CODE (UOC) | (7)<br>QTY |
|--------------------|--------------------|------------------|--------------|--------------------|--|------------|
|                    |                    |                  |              |                    | GROUP 03 FRAME MEMBERS,<br>SECONDARY           |            |
|                    |                    |                  |              |                    | FIG. 4 CONTAINER ASSEMBLY AND<br>HARDWARE      |            |
| 1                  | XBOOZ              |                  | 90598        | 30301-100          | BOX ASSEMBLY.....                              | 1          |
| 2                  | XBOZZ              |                  | 90598        | 30400-100          | LADDER.....                                    | 1          |
| 3                  | PAOZZ              | 5315-00-682-2057 | 96906        | MS9048-104         | PIN, SPRING.....                               | 2          |
| 4                  | PAOZZ              | 5310-00-809-5998 | 96906        | MS27183-18         | WASHER, FLAT.....                              | 2          |
| 5                  | XBOZZ              |                  | 90598        | 30399-1            | KNOB, HAND.....                                | 2          |
| 6                  | XBOZZ              |                  | 90598        | 30413-100          | CHAIN ASSY.....                                | 1          |
| 7                  | XBOZZ              |                  | 90598        | 30414-100          | BLOCK, SPACER.....                             | 1          |
| 8                  | XBHZZ              |                  | 92967        | D6809-02           | FITTING, TOP CORNER.....                       | 2          |
| 9                  | XBHZZ              |                  | 92967        | D6808-01           | FITTING, BOTTOM.....                           | 2          |
| 10                 | XBHZZ              |                  | 92967        | D6808-02           | FITTING, BOTTOM.....                           | 2          |
| 11                 | XBHZZ              |                  | 92967        | D6809-01           | FITTING, TOP CORNER.....                       | 2          |
|                    |                    |                  |              |                    | END OF FIGURE                                  |            |

THIS PAGE INTENTIONALLY LEFT BLANK

THIS PAGE INTENTIONALLY LEFT BLANK

---

ORGANIZATIONAL, DIRECT, AND GENERAL SUPPORT MAINTENANCE  
(INCLUDING DEPOT MAINTENANCE REPAIR)

CONTAINER, REFRIGERATED  
MODEL SC209, NSN: 8115-01-016-5909

FRAME MEMBERS, SECONDARY

REPAIR PARTS LIST

---

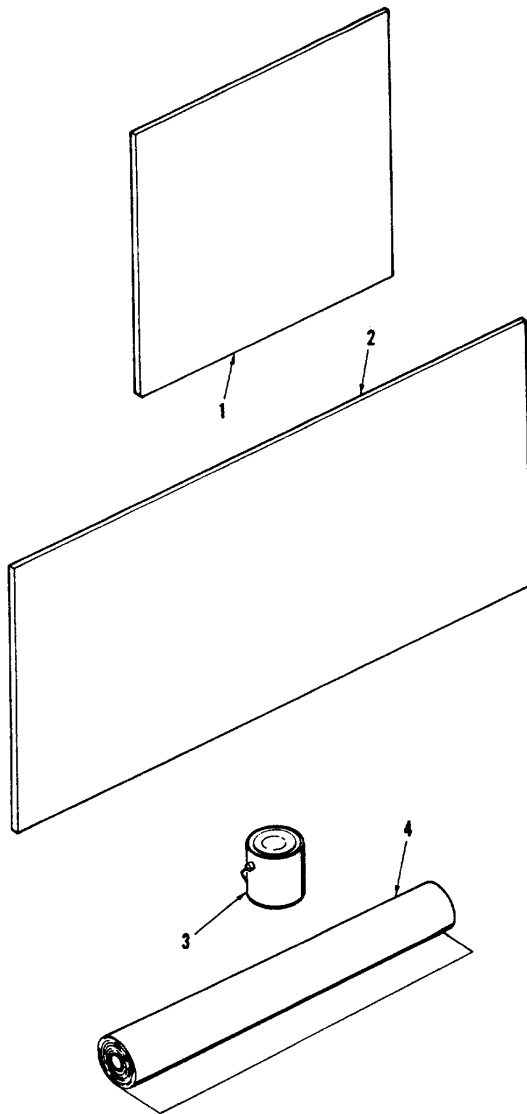

ME-8115-202-24P/5

Figure 5. Repair Panels and Materials

| (1)<br>ITEM<br>NO. | (2)<br>SMR<br>CODE | (3)<br>NSN       | (4)<br>CAGEC | (5)<br>PART NUMBER | (6)<br>DESCRIPTION AND USABLE ON<br>CODE (UOC) | (7)<br>QTY |
|--------------------|--------------------|------------------|--------------|--------------------|--|------------|
|                    |                    |                  |              |                    | GROUP 03 FRAME MEMBERS,<br>SECONDARY           |            |
|                    |                    |                  |              |                    | FIG. 5 REPAIR PANELS AND<br>MATERIALS          |            |
| 1                  | PAFZZ              | 8115-01-066-6052 | 90598        | 30447-1            | PANEL, 3-8, REPAIR.....                        | 1          |
| 2                  | PAFZZ              | 8115-01-066-6053 | 90598        | 30447-2            | PANEL, 5-8, REPAIR.....                        | 1          |
| 3                  | PAFZZ              |                  | 90598        | 30448              | RESIN & CATALYST.....                          | 1          |
| 4                  | PAFZZ              |                  | 90598        | 30449              | CLOTH, FIBERGLASS.....                         | 1          |
|                    |                    |                  |              |                    | END OF FIGURE                                  |            |

THIS PAGE INTENTIONALLY LEFT BLANK



THIS PAGE INTENTIONALLY LEFT BLANK

ORGANIZATIONAL, DIRECT, AND GENERAL SUPPORT MAINTENANCE  
(INCLUDING DEPOT MAINTENANCE REPAIR)

CONTAINER, REFRIGERATED  
MODEL SC209, NSN: 8115-01-016-5909

THERMOMETER ASSEMBLY

REPAIR PARTS LIST

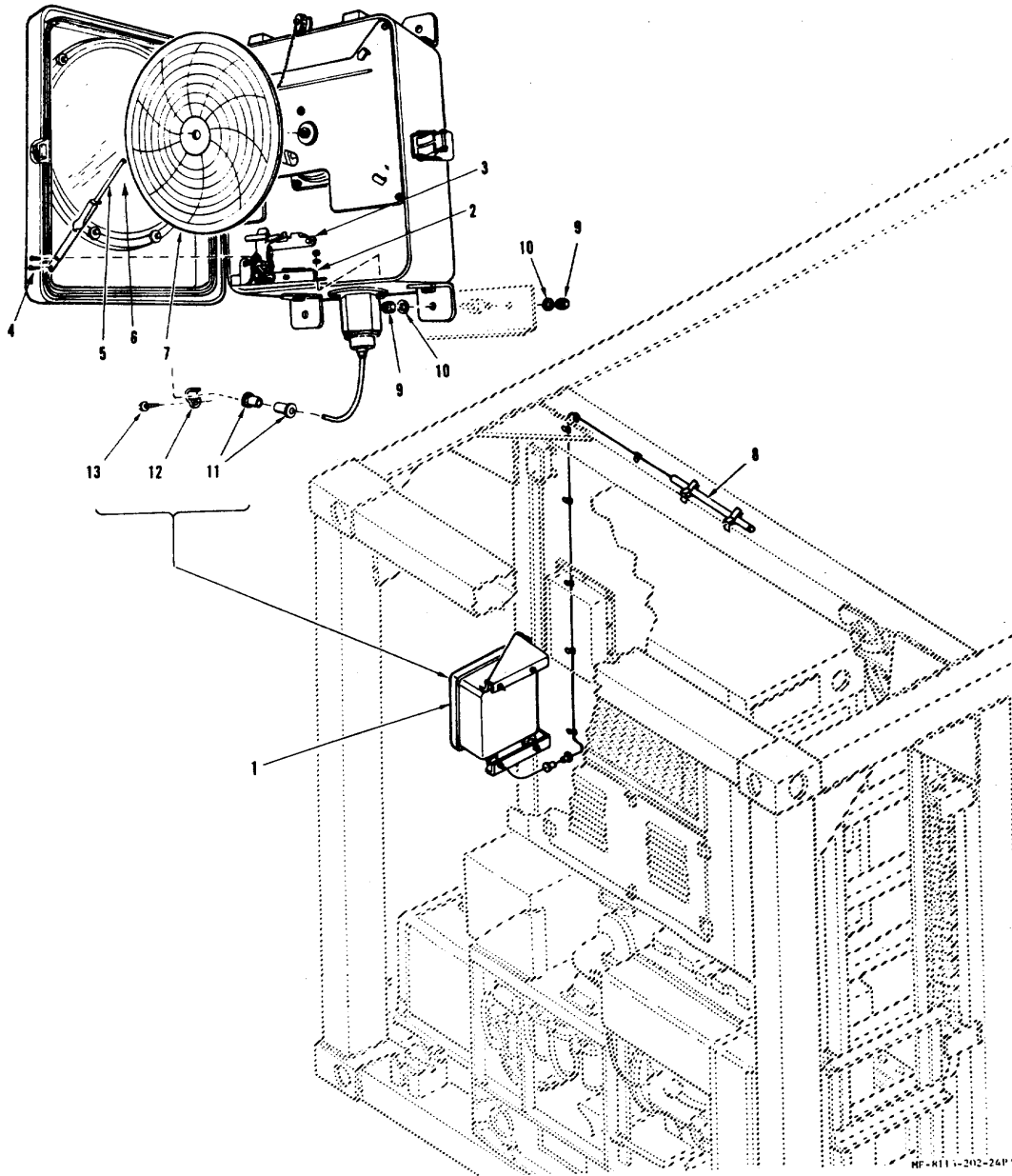

Figure 6. Thermometer Assembly

| (1)<br>ITEM<br>NO. | (2)<br>SMR<br>CODE | (3)<br>NSN       | (4)<br>CAGEC | (5)<br>PART NUMBER | (6)<br>DESCRIPTION AND USABLE ON<br>CODE (UOC) | (7)<br>QTY |
|--------------------|--------------------|------------------|--------------|--------------------|--|------------|
|                    |                    |                  |              |                    | GROUP 4 THERMOMETER<br>ASSEMBLY                |            |
|                    |                    |                  |              |                    | FIG. 6 THERMOMETER<br>ASSEMBLY                 |            |
| 1                  | PAOZZ              | 6685-01-072-0480 | 90598        | 30416              | THERMOMETER.....                               | 1          |
| 2                  | PAOZZ              |                  | 45809        | S832-010-B1A-A2    | SCREW, MECHANISM HOLDING...                    | 1          |
| 3                  | PAOZZ              |                  | 45809        | TRDW-51            | MECHANISM ASSEMBLY.....                        | 1          |
| 4                  | PAOZZ              |                  | 45809        | S256-002-A1A-83    | SCREW, PEN MOUNT.....                          | 2          |
| 5                  | PAOZZ              |                  | 45809        | 50009801           | BLADE, PEN.....                                | 1          |
| 6                  | PAOZZ              |                  | 45809        | 64401703           | TIP, PEN.....                                  | 1          |
| 7                  | PAOZZ              |                  | 45809        | D217F31D2-DEG.DIV  | .CHART.....                                    | 1          |
| 8                  | PAOZZ              | 6685-01-072-0073 | 45809        | 217KLSP220-8       | .ELEMENT.....                                  | 1          |
| 9                  | PAOZZ              | 5310-00-761-6882 | 96906        | MS51967-2          | NUT, PLAIN, HEX.....                           | 8          |
| 10                 | PAOZZ              | 5310-00-550-1130 | 96906        | MS35333-40         | WASHER, LOCK.....                              | 8          |
| 11                 | PAOZZ              |                  | 77969        | 3885               | GROMMET.....                                   | 2          |
| 12                 | PAOZZ              | 5340-00-733-7902 | 95987        | 1-8-3NA            | CLAMP, LOOP.....                               | 5          |
| 13                 | PAOZZ              | 5320-01-074-1543 | 94222        | 38-106-12-91       | RIVET.....                                     | 5          |
|                    |                    |                  |              |                    | END OF FIGURE                                  |            |

THIS PAGE INTENTIONALLY LEFT BLANK

THIS PAGE INTENTIONALLY LEFT BLANK

ORGANIZATIONAL, DIRECT, AND GENERAL SUPPORT MAINTENANCE  
(INCLUDING DEPOT MAINTENANCE REPAIR)

CONTAINER, REFRIGERATED  
MODEL SC209, NSN: 8115-01-016-5909

FUEL TANK ASSEMBLY

REPAIR PARTS LIST

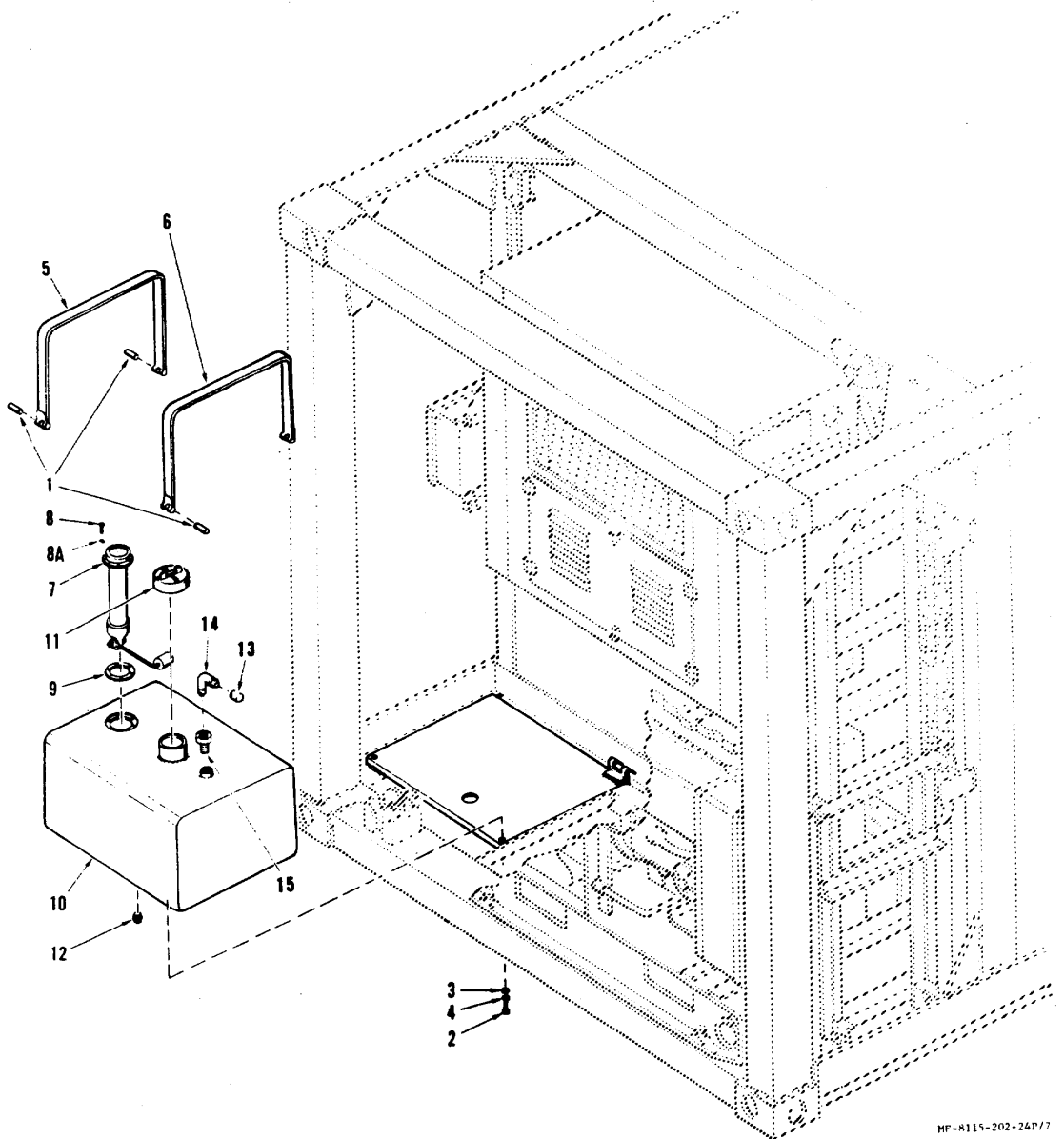

MP-8115-202-24P/7

Figure 7. Fuel Tank Assembly

| (1)<br>ITEM<br>NO.          | (2)<br>SMR<br>CODE | (3)<br>NSN       | (4)<br>CAGEC | (5)<br>PART NUMBER | (6)<br>DESCRIPTION AND USABLE ON<br>CODE (UOC) | (7)<br>QTY |
|-----------------------------|--------------------|------------------|--------------|--------------------|--|------------|
| GROUP 05 FUEL TANK ASSEMBLY |                    |                  |              |                    |  |            |
| FIG. 7 FUEL TANK ASSEMBLY   |                    |                  |              |                    |  |            |
| 1                           | PAOZZ              | 5310-01-079-6537 | 90598        | TT403              | NUT,BARREL.....                                | 3          |
| 2                           | PAOZZ              | 5305-00-269-3217 | 96906        | MS90725-67         | SCREW,CAP.....                                 | 3          |
| 3                           | PAOZZ              | 5310-00-080-6004 | 96906        | MS27183-14         | WASHER,FLAT.....                               | 3          |
| 4                           | PAOZZ              | 5310-00-637-9541 | 96906        | MS35338-46         | WASHER,LOCK.....                               | 3          |
| 5                           | XBOZZ              |                  | 90598        | 30306-1            | STRAP,FUEL TANK .....                          | 1          |
| 6                           | XBOZZ              |                  | 90598        | 30307-1            | STRAP,FUEL TANK .....                          | 1          |
| 7                           | PAZZ               | 6680-01-072-2493 | 09393        | 6781-00236         | GAGE, FUEL.....                                | 1          |
| 8                           | PAOZZ              | 5305-00-989-7435 | 96906        | MS35207-264        | SCREW,MACHINE .....                            | 5          |
| 9                           | PAOZZ              | 5330-01-074-3866 | 09393        | 15-423             | GASKET.....                                    | 1          |
| 9A                          | PAOZZ              | 5310-00-045-3296 | 96906        | MS35338-43         | WASHER,LOCK.....                               | 5          |
| 10                          | PAOZZ              | 2910-01-073-6023 | 90598        | 30305-100          | TANK,FUEL.....                                 | 1          |
| 11                          | PAOZZ              | 2910-00-994-2536 | 18163        | DGF38              | .CAP,FUEL TANK.....                            | 1          |
| 12                          | XBOZZ              |                  | 78252        | 23535017           | .PLUG,PIPE.....                                | 1          |
| 13                          | XBOZZ              |                  | 30327        | 830-FS-05          | CAP,TUBE .....                                 | 1          |
| 14                          | PAOZZ              |                  | 30327        | 849FS-05X04        | ELBOW,PIPE .....                               | 1          |
| 15                          | PAOZZ              |                  | 30327        | 245B-08X04         | REDUCER,PIPE.....                              | 1          |
| END OF FIGURE               |                    |                  |              |                    |  |            |

THIS PAGE INTENTIONALLY LEFT BLANK



THIS PAGE INTENTIONALLY LEFT BLANK

ORGANIZATIONAL, DIRECT, AND GENERAL SUPPORT MAINTENANCE  
(INCLUDING DEPOT MAINTENANCE REPAIR)

CONTAINER, REFRIGERATED  
MODEL SC209, NSN: 8115-01-016-5909

EXHAUST SHIELD AND PIPES

REPAIR PARTS LIST

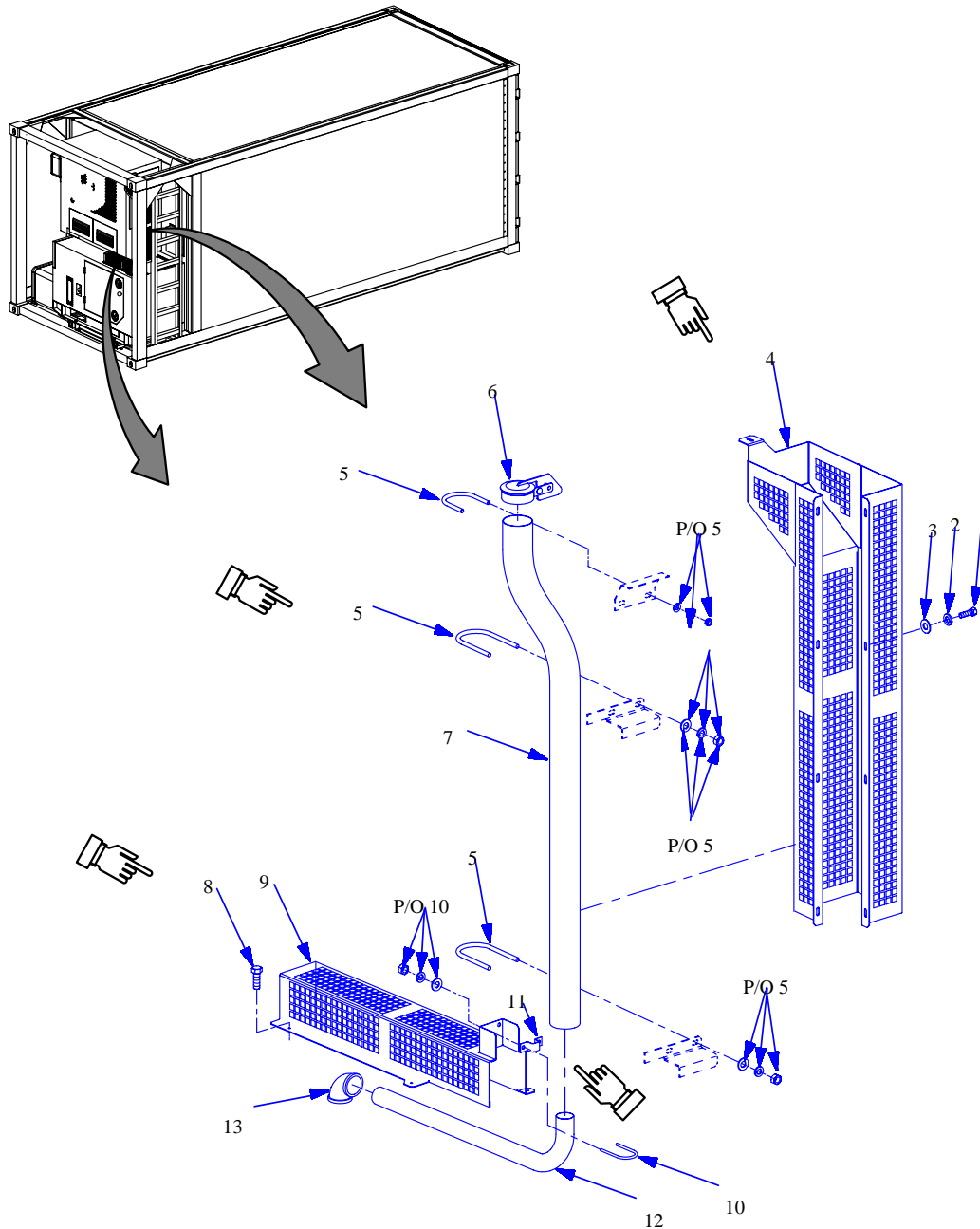

Figure 8. Exhaust Pipe Assemblies

| (1)<br>ITEM<br>NO. | (2)<br>SMR<br>CODE | (3)<br>NSN       | (4)<br>CAGEC | (5)<br>PART NUMBER | (6)<br>DESCRIPTION AND USABLE ON<br>CODE (UOC) | (7)<br>QTY |
|--------------------|--------------------|------------------|--------------|--------------------|--|------------|
|                    |                    |                  |              |                    | GROUP 06 EXHAUST SHIELD AND<br>PIPES           |            |
|                    |                    |                  |              |                    | FIG. 8 EXHAUST PIPE ASSEMBLIES                 |            |
| 1                  | PAOZZ              | 5305-00-984-6212 | 96906        | MS35206-265        | SCREW,MACHINE .....                            | 9          |
| 2                  | PAOZZ              | 5310-00-045-3296 | 96906        | MS35338-43         | WASHER,LOCK .....                              | 9          |
| 3                  | PAOZZ              | 5310-00-014-5850 | 96906        | MS27183-42         | WASHER,FLAT.....                               | 3          |
| 4                  | PAOZZ              | 2990-01-480-9202 | 90598        | 30741-100          | SHIELD ASSEMBLY .....                          | 1          |
| 5                  | PAOZZ              | 5306-00-234-9731 | 39428        | 3043T32            | VERTICAL<br>U-BOLT,2.50 ID.....                | 3          |
| 6                  | PAOZZ              | 2990-01-480-9201 | 10066        | 22-250             | CAP,RAIN .....                                 | 1          |
| 7                  | PAOZZ              | 2990-01-480-9199 | 90598        | 30697-1            | PIPE,EXHAUST, VERTICAL .....                   | 1          |
| 8                  | PAOZZ              | 5305-01-481-3190 | 39428        | 91324A430          | SCREW,SELF-DRILLING.....                       | 3          |
| 9                  | PAOZZ              | 2990-01-480-9188 | 90598        | 30711-100          | SHIELD,EXHAUST.....                            | 1          |
| 10                 | PAOZZ              | 5306-01-244-8868 | 39428        | 3043T18            | HORIZONTAL<br>U-BOLT,1.50 ID.....              | 1          |
| 11                 | XBOZZ              |                  | 90598        | 30747-1            | SPACER EXHAUST .....                           | 1          |
| 12                 | PAOZZ              | 2990-01-480-9193 | 90598        | 30696-1            | PIPE,EXHAUST.....                              | 1          |
| 13                 | XBOZZ              |                  | 39428        | 44605K117          | HORIZONTAL<br>ELBOW,90 DEG, 1.25NPT .....      | 1          |
|                    |                    |                  |              |                    | END OF FIGURE                                  |            |

THIS PAGE INTENTIONALLY LEFT BLANK

THIS PAGE INTENTIONALLY LEFT BLANK

ORGANIZATIONAL, DIRECT, AND GENERAL SUPPORT MAINTENANCE  
(INCLUDING DEPOT MAINTENANCE REPAIR)

CONTAINER, REFRIGERATED  
MODEL SC209, NSN: 8115-01-016-5909

ELECTRICAL EQUIPMENT AND SPACERS

REPAIR PARTS LIST

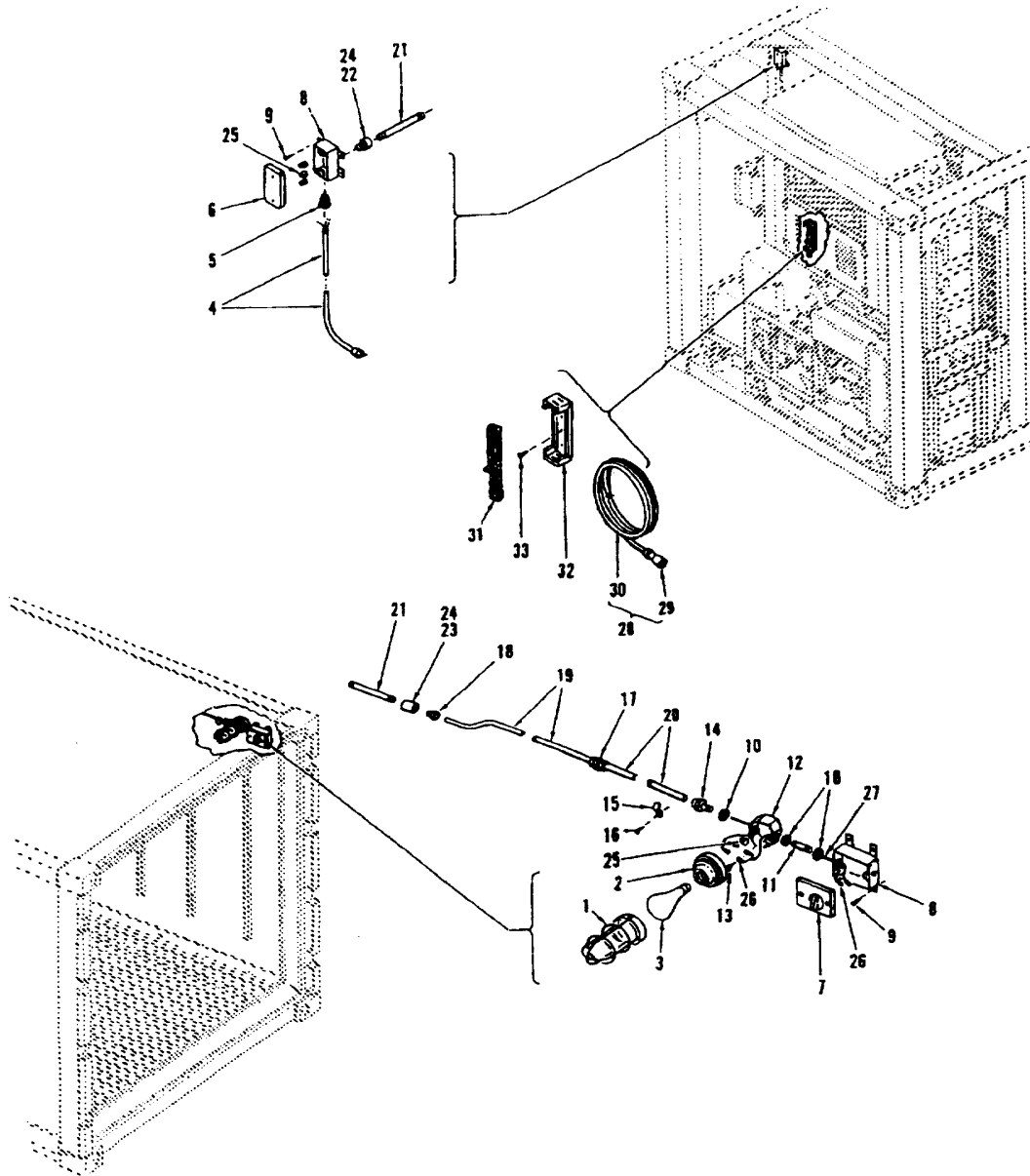

Figure 9. Light Assembly and Power Cable Assembly

| (1)<br>ITEM<br>NO.                                | (2)<br>SMR<br>CODE | (3)<br>NSN       | (4)<br>CAGEC | (5)<br>PART NUMBER | (6)<br>DESCRIPTION AND USABLE ON<br>CODE (UOC) | (7)<br>QTY |
|---|--------------------|------------------|--------------|--------------------|--|------------|
| GROUP 07 ELECTRICAL<br>EQUIPMENT AND SPACERS      |                    |                  |              |                    |  |            |
| FIG. 9 LIGHT ASSEMBLY AND<br>POWER CABLE ASSEMBLY |                    |                  |              |                    |  |            |
| 1   | PAOZZ              |                  | 72268        | VG1                | GUARD, LAMP.....                               | 1          |
| 2   | PAOZZ              |                  | 72268        | VC150              | FIXTURE.....                                   | 1          |
| 3   | PAOZZ              | 6240-01-007-7637 | 08805        | 100A               | LAMP, INCANDESCENT.....                        | 1          |
| 4   | PAOZZ              | 6150-00-198-7395 | 70903        | 17409              | CORD, POWER.....                               | 1          |
| 5   | PAOZZ              | 5975-00-296-1669 | 59730        | 2521               | BUSHING, STR. REL.....                         | 1          |
| 6   | XBOZZ              | 5975-01-106-6037 | 28488        | 5173-0             | COVER, BOX.....                                | 1          |
| 7   | PAOZZ              |                  | 08556        | 216                | COVER WITH SWITCH.....                         | 1          |
| 8   | XBOZZ              |                  | 08556        | 250L               | BOX, OUTLET.....                               | 2          |
| 9   | PAOZZ              | 5305-00-180-1991 | 96906        | MS35493-78         | SCREW, WOOD.....                               | 8          |
| 10  | XBOZZ              |                  | 59730        | 151                | LOCKNUT, CONDUIT.....                          | 3          |
| 11  | XBOZZ              |                  | 80996        | FIG343             | NIPPLE, PIPE.....                              | 1          |
| 12  | XBOZZ              |                  | 90598        | 30411-1            | HOLDER, LAMP.....                              | 1          |
| 13  | PAOZZ              | 5305-00-180-1991 | 96906        | MS35493-78         | SCREW, WOOD.....                               | 2          |
| 14  | XBOZZ              |                  | 07337        | 1001               | CONNECTOR, BOX.....                            | 1          |
| 15  | XBOZZ              |                  | 83209        | 260                | CLAMP, CONDUIT.....                            | 7          |
| 16  | PAOZZ              | 5305-00-180-1991 | 96906        | MS35493-78         | SCREW, WOOD.....                               | 7          |
| 17  | XBOZZ              |                  | 03743        | 95T050             | COUPLING, PIPE.....                            | 1          |
| 18  | XBOZZ              | 5975-00-179-0098 | 03743        | 96T050             | CONNECTOR, BOX.....                            | 1          |
| 19  | XBOZZ              |                  | 90598        | 30410-1            | CONDUIT, FORMED.....                           | 1          |
| 20  | XBOZZ              |                  | 90598        | 30302-25           | CONDUIT.....                                   | 1          |
| 21  | XBOZZ              |                  | 90598        | 30302-21           | CONDUIT.....                                   | 1          |
| 22  | XBOZZ              |                  | 93908        | E943D              | ADAPTER, CONDUIT.....                          | 1          |
| 23  | XBOZZ              |                  | 93908        | E942D              | ADAPTER, CONDUIT.....                          | 1          |
| 24  | PAOZZ              |                  | 04963        | 1099               | SEALER, PVC.....                               | 1          |

| (1)<br>ITEM<br>NO. | (2)<br>SMR<br>CODE | (3)<br>NSN       | (4)<br>CAGEC | (5)<br>PART NUMBER | (6)<br>DESCRIPTION AND USABLE ON<br>CODE (UOC) | (7)<br>QTY |
|--------------------|--------------------|------------------|--------------|--------------------|--|------------|
|                    |                    |                  |              |                    | GROUP 07 ELECTRICAL<br>EQUIPMENT AND SPACERS   |            |
|                    |                    |                  |              |                    | FIG. 9 LIGHT ASSEMBLY AND<br>POWER CABLE       |            |
| 25                 | XBOZZ              |                  | 20999        | Y                  | SPLICE, CONDUIT.....                           | 4          |
| 26                 | PAOZZ              | 5940-00-143-4774 | 96906        | MS25036-153        | TERMINAL, LOG.....                             | 5          |
| 27                 | PAOZZ              |                  | 81349        | MILW5086-1-14      | WIRE, ELECTRIC.....                            | 1          |
| 28                 | XBOOZ              |                  | 90598        | 30442-100          | CABLE ASSEMBLY.....                            | 1          |
| 29                 | PAOZZ              |                  | 90598        | 534FC              | .CONNECTOR, ELECT.....                         | 1          |
| 30                 | PAOZZ              |                  | 81349        | C005HLF-100750     | .CABLE,.....                                   | 1          |
| 31                 | PAOZZ              |                  | 39428        | 9587H61            | STRAP.....                                     | 1          |
| 32                 | XBOZZ              |                  | 90598        | 30441-1            | BRACKET, CABLE.....                            | 1          |
| 33                 | PAOZZ              | 5305-00-056-7879 | 96906        | MS35493-74         | SCREW, WOOD.....                               | 4          |
|                    |                    |                  |              |                    | END OF FIGURE                                  |            |



THIS PAGE INTENTIONALLY LEFT BLANK

---

**ORGANIZATIONAL, DIRECT, AND GENERAL SUPPORT MAINTENANCE  
(INCLUDING DEPOT MAINTENANCE REPAIR)**

**CONTAINER, REFRIGERATED  
MODEL SC209, NSN: 8115-01-016-5909**

**ELECTRICAL EQUIPMENT AND SPACERS**

**REPAIR PARTS LIST**

---

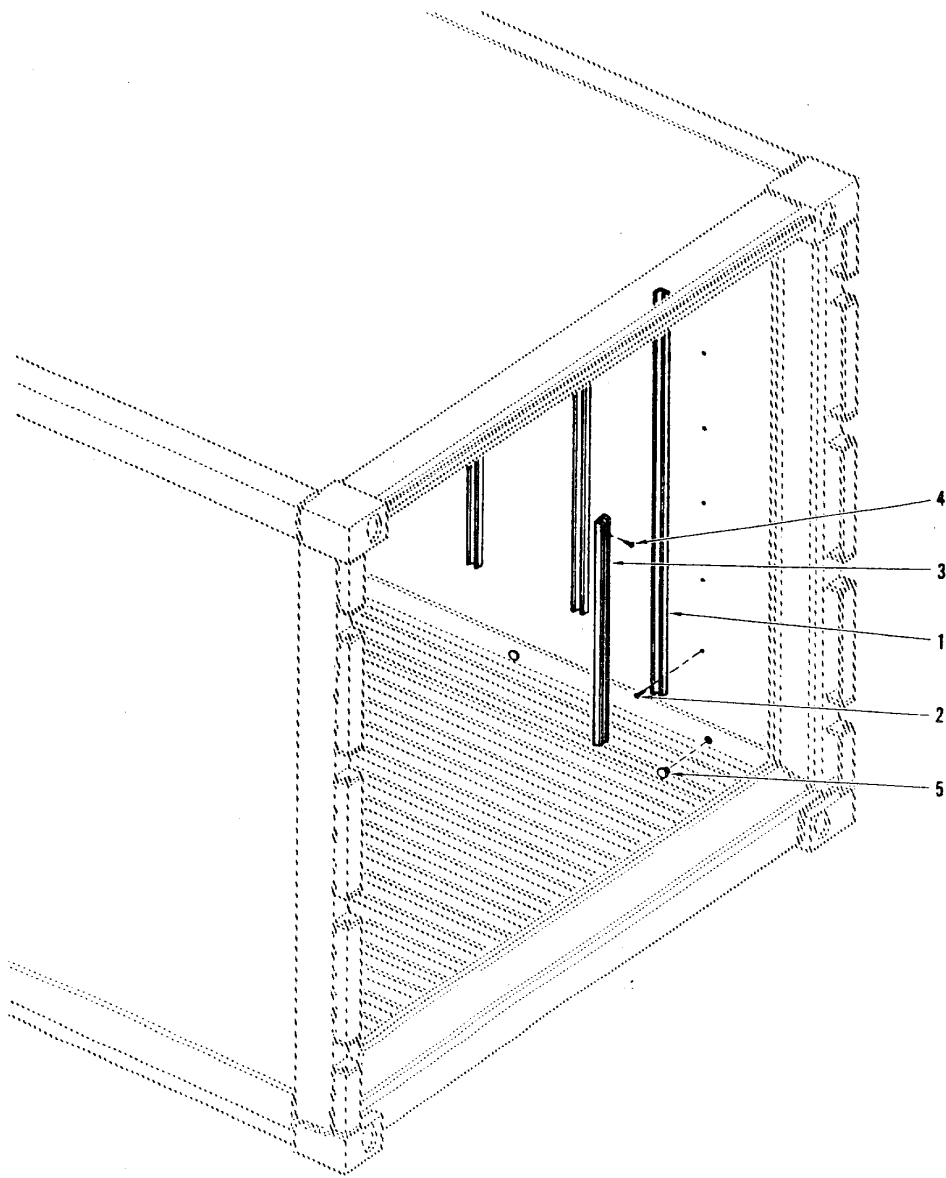

ME-8115-202-24P/10

Figure 10. Air Flow Spacers and Button Plugs

| (1)<br>ITEM<br>NO. | (2)<br>SMR<br>CODE | (3)<br>NSN       | (4)<br>CAGEC | (5)<br>PART NUMBER | (6)<br>DESCRIPTION AND USABLE ON<br>CODE (UOC) | (7)<br>QTY |
|--------------------|--------------------|------------------|--------------|--------------------|--|------------|
|                    |                    |                  |              |                    | GROUP 07 ELECTRICAL<br>EQUIPMENT AND SPACERS   |            |
|                    |                    |                  |              |                    | FIG. 10 AIR FLOW SPACERS AND<br>BUTTON PLUGS   |            |
| 1                  | PAOZZ              | 5365-01-074-1887 | 90598        | 30438-1            | SPACER.....                                    | 24         |
| 2                  | PAOZZ              | 5305-00-180-1991 | 96906        | MS35493-78         | SCREW, WOOD.....                               | 153        |
| 3                  | PAOZZ              | 5365-01-074-1888 | 90598        | 30438-2            | SPACER.....                                    | 3          |
| 4                  | PAOZZ              | 5365-00-180-1991 | 96906        | MS35493-78         | SCREW, WOOD.....                               | 15         |
| 5                  | PAOZZ              |                  | 83053        | NS48143            | PLUG, BUTTON.....                              | 44         |
| 6                  | PAOZZ              | 8115-01-204-3087 | 01276        | FE725-01-120       | TRACK, ALUMINUM SERIES A.....                  | 12         |
| 7                  | PAOZZ              | 9540-01-206-4927 | 01276        | FE8000-1           | BEAM, ALUMINUM SERIES E.....                   | 10         |
| 8                  | PAOZZ              | 5305-00-782-4389 | 96906        | MS51861-67         | SCREW, SHEET METAL.....                        | 525        |
|                    |                    |                  |              |                    | END OF FIGURE                                  |            |

THIS PAGE INTENTIONALLY LEFT BLANK

THIS PAGE INTENTIONALLY LEFT BLANK

ORGANIZATIONAL, DIRECT, AND GENERAL SUPPORT MAINTENANCE  
(INCLUDING DEPOT MAINTENANCE REPAIR)

CONTAINER, REFRIGERATED  
MODEL SC209, NSN: 8115-01-016-5909

REFRIGERATION UNIT

REPAIR PARTS LIST

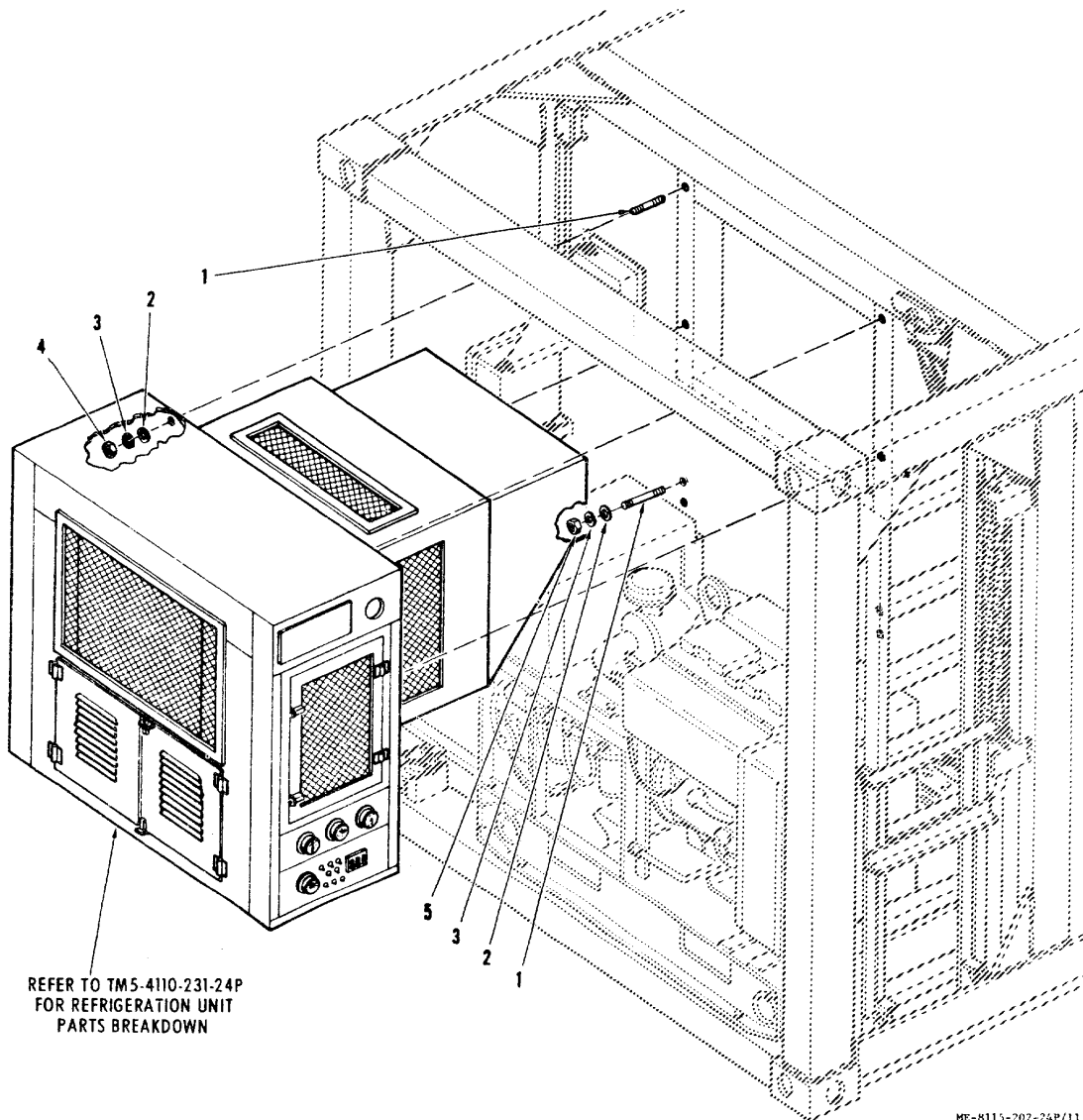

Figure 11. Refrigeration Unit

| (1)<br>ITEM<br>NO. | (2)<br>SMR<br>CODE | (3)<br>NSN       | (4)<br>CAGEC | (5)<br>PART NUMBER | (6)<br>DESCRIPTION AND USABLE ON<br>CODE (UOC) | (7)<br>QTY |
|--------------------|--------------------|------------------|--------------|--------------------|--|------------|
|                    |                    |                  |              |                    | GROUP 08 REFRIGERATION UNIT                    |            |
|                    |                    |                  |              |                    | FIG 11. REFRIGERATION UNIT                     |            |
| 1                  | XBOZZ              |                  | 39248        | 91563A3-4-10X3     | STUD, THREADED                                 | 8          |
| 2                  | PAOZZ              | 5310-00-809-8533 | 96906        | MS27183-23         | WASHER, FLAT                                   | 8          |
| 3                  | PAOZZ              | 5310-00-584-7888 | 96906        | MS35338-51         | WASHER, LOCK                                   | 8          |
| 4                  | PAOZZ              | 5310-00-763-8921 | 96906        | MS51967-23         | NUT. PLAIN, HEX                                | 4          |
| 5                  | PAOZZ              | 5310-01-077-1930 | 77122        | RF3410             | NUT, STAMPED                                   | 4          |
|                    |                    |                  |              |                    | END OF FIGURE                                  |            |

THIS PAGE INTENTIONALLY LEFT BLANK



THIS PAGE INTENTIONALLY LEFT BLANK

ORGANIZATIONAL, DIRECT, AND GENERAL SUPPORT MAINTENANCE  
(INCLUDING DEPOT MAINTENANCE REPAIR)

CONTAINER, REFRIGERATED  
MODEL SC209, NSN: 8115-01-016-5909

GENERATOR SET AND MOUNTING HARDWARE

REPAIR PARTS LIST

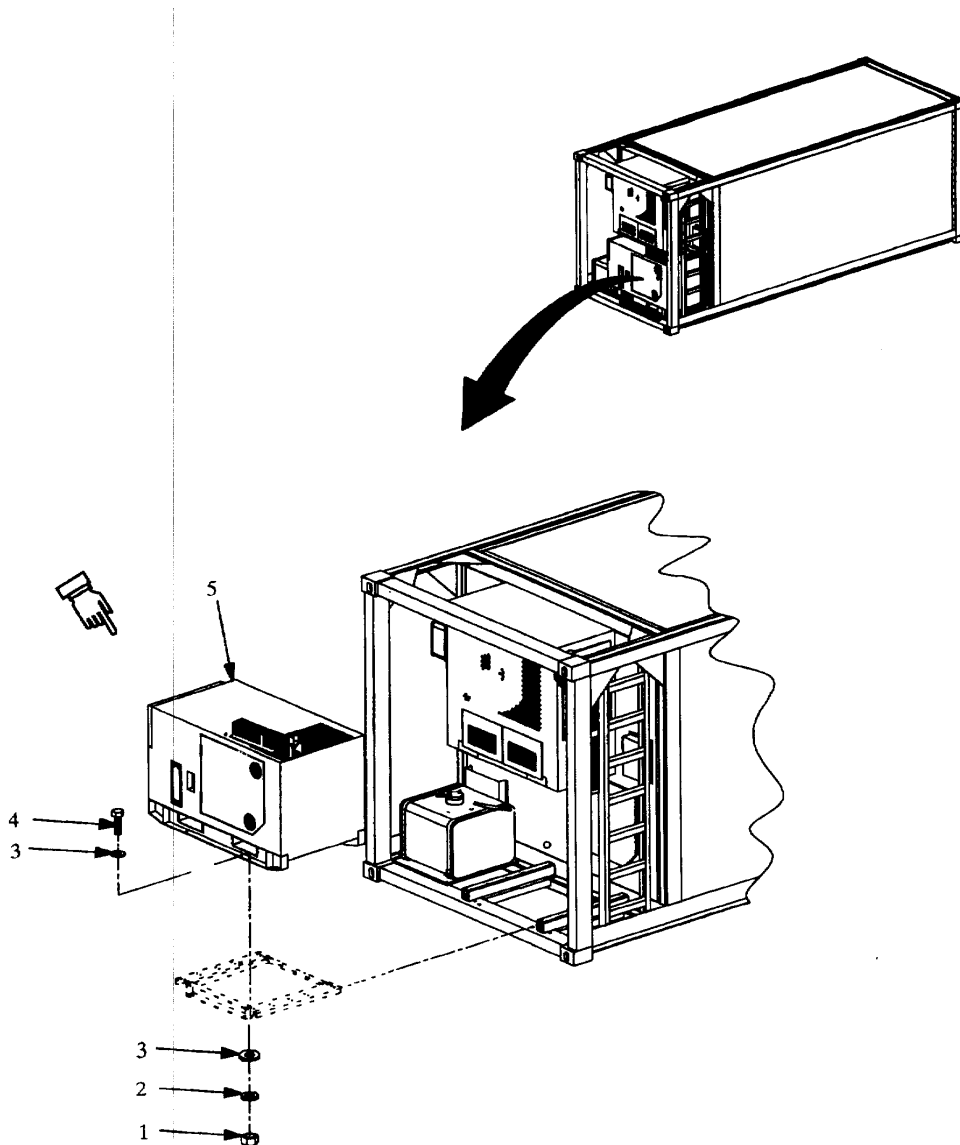

Figure 12. Generator Set and Mounting Hardware

| (1)<br>ITEM<br>NO. | (2)<br>SMR<br>CODE | (3)<br>NSN       | (4)<br>CAGEC | (5)<br>PART NUMBER | (6)<br>DESCRIPTION AND USABLE ON<br>CODE (UOC)                            | (7)<br>QTY |
|--------------------|--------------------|------------------|--------------|--------------------|---|------------|
|                    |                    |                  |              |                    | GROUP: 09 GENERATOR<br>SET AND MOUNTING<br>HARDWARE                       |            |
|                    |                    |                  |              |                    | FIG. 12 GENERATOR SET<br>AND MOUNTING<br>HARDWARE                         |            |
| 1                  | PAOZZ              | 5310-01-270-1731 | 96906        | MS51967-14         | NUT,PLAIN,HEXAGON.....  | 4          |
| 2                  | PAOZZ              | 5310-01-335-4901 | 96906        | MS35338-48         | WASHER,LOCK.....  | 4          |
| 3                  | PAOZZ              | 5310-00-809-5998 | 96906        | MS27183-18         | WASHER,FLAT.....  | 8          |
| 4                  | PAOZZ              | 5305-01-325-8388 | 96906        | MS90725-113        | SCREW,CAP,HEXAGON.....  | 4          |
| 5                  | PAOFD              | 6115-01-275-5061 | 30554        | MEP 803A           | GENERATOR SET,DIESEL<br>ENGINE (REFER TO TM<br>9-6115-642-24P FOR REPAIR) | 1          |
|                    |                    |                  |              |                    | END OF FIGURE   |            |

THIS PAGE INTENTIONALLY LEFT BLANK

THIS PAGE INTENTIONALLY LEFT BLANK

ORGANIZATIONAL, DIRECT, AND GENERAL SUPPORT MAINTENANCE  
(INCLUDING DEPOT MAINTENANCE REPAIR)

CONTAINER, REFRIGERATED  
MODEL SC209, NSN: 8115-01-016-5909

SLIDE ASSEMBLY AND MOUNTING HARDWARE

REPAIR PARTS LIST

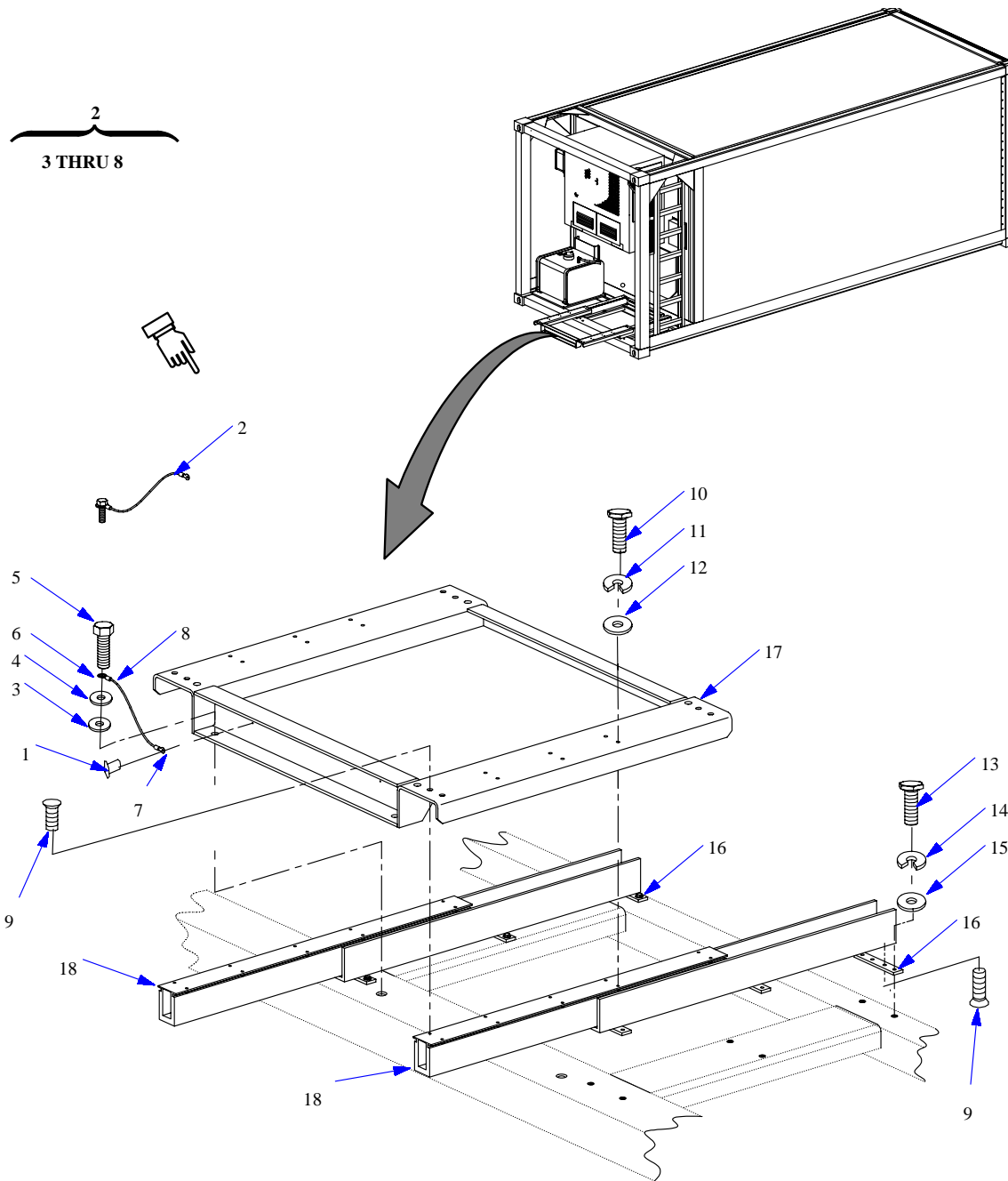

Figure 13. Generator Set Slide Unit and Mounting Hardware

| (1)<br>ITEM<br>NO. | (2)<br>SMR<br>CODE | (3)<br>NSN       | (4)<br>CAGEC | (5)<br>PART NUMBER    | (6)<br>DESCRIPTION AND USABLE ON<br>CODE (UOC)               | (7)<br>QTY |
|--------------------|--------------------|------------------|--------------|-----------------------|--|------------|
|                    |                    |                  |              |                       | GROUP: 10 SLIDE<br>ASSEMBLY AND MOUNTING<br>HARDWARE         |            |
|                    |                    |                  |              |                       | FIG. 13 GENERATOR SET<br>SLIDE UNIT AND MOUNTING<br>HARDWARE |            |
| 1                  | PAOZZ              | 5320-00-882-8385 | 81348        | M24243/6A-<br>606H    | RIVET,BLIND,CLOSED .....                                     | 2          |
| 2                  | XBOZZ              |                  | 90598        | 30695-100             | BOLT,LOCKING .....   | 2          |
| 3                  | PAOZZ              |                  | 78553        | T99220-SS-<br>120-576 | .RING,RETAINING .....  | 1          |
| 4                  | PAOZZ              | 5310-00-809-5997 | 96906        | MS27183-17            | .WASHER,FLAT .....   | 1          |
| 5                  | PAOZZ              | 5305-00-782-9494 | 96906        | MS90725-114           | .SCREW,CAP,HEXAGON.....                                      | 1          |
| 6                  | PAOZZ              | 5940-00-682-2445 | 96906        | MS25036-158           | .TERMINAL,LUC NO.50 .....                                    | 1          |
| 7                  | PAOZZ              | 5940-00-143-4794 | 96906        | MS25036-112           | .TERMINAL,LUC NO.50 .....                                    | 1          |
| 8                  | MOOZZ              |                  | 90598        | 30695-5               | .ROPE,WIRE,.06DIA .....                                      | 1          |
|                    |                    |                  |              |                       | (MAKE FROM P/N M83420/3-<br>001,CAGEC 81349, 7 IN)           |            |
| 9                  | PAOZZ              | 5305-00-954-4295 | 96906        | MS35190-287           | SCREW,MACHINE .....  | 20         |
| 10                 | PAOZZ              | 5305-00-068-0501 | 96906        | MS90725-5             | SCREW,CAP,HEXAGON<br>HEAD.....                               | 12         |
| 11                 | PAOZZ              | 5310-00-582-5965 | 96906        | MS35338-44            | WASHER,LOCK .....  | 12         |
| 12                 | PAOZZ              | 5310-00-809-4058 | 96906        | MS27183-10            | WASHER,FLAT.....   | 12         |
| 13                 | PAOZZ              | 5306-00-225-8501 | 96906        | MS90725-37            | BOLT,HEXAGON HEAD.....                                       | 12         |
| 14                 | PAOZZ              | 5310-01-338-7338 | 96906        | MS35338-45            | WASHER,LOCK .....  | 12         |
| 15                 | PAOZZ              | 5310-00-081-4219 | 96906        | MS27183-12            | WASHER,FLAT .....  | 12         |
| 16                 | XBOZZ              |                  | 90598        | 30670-1               | MOUNT,SLIDE.....   | 6          |
| 17                 | PAOZZ              | 5340-01-480-2925 | 90598        | 30669-100             | MOUNT,GENERATOR.....   | 1          |
| 18                 | XBOZZ              |                  | 06666        | CD5601-00-<br>0320    | SLIDE ASSEMBLY .....   | 2          |
|                    |                    |                  |              |                       | END OF FIGURE  |            |

THIS PAGE INTENTIONALLY LEFT BLANK



**ORGANIZATIONAL, DIRECT, AND GENERAL SUPPORT MAINTENANCE  
(INCLUDING DEPOT MAINTENANCE REPAIR)**

**CONTAINER, REFRIGERATED  
MODEL SC209, NSN: 8115-01-016-5909**

**BULK ITEMS**

**REPAIR PARTS LIST**

| (1)<br>ITEM<br>NO    | (2)<br>SMR<br>CODE | (3)<br>NSN       | (4)<br>CAGEC | (5)<br>PART<br>NUMBER    | (6)<br>DESCRIPTION AND<br>USABLE ON CODE (UOC) | (7)<br>QTY |
|----------------------|--------------------|------------------|--------------|--------------------------|--|------------|
| GROUP: 11 BULK ITEMS |                    |                  |              |                          |  |            |
| FIG. BULK ITEMS      |                    |                  |              |                          |  |            |
| 1                    | XDOZZ              |                  | 86730        | 4111D1/8X2               | GASKET,RUBBER.....                             | V          |
| 2                    | PAOZZ              | 5330-01-074-1355 | 86730        | 4111D1/8X3               | GASKET,RUBBER.....                             | V          |
| 3                    | PAOZZ              | 6145-00-617-1368 | 81349        | CO-04HLF<br>(4/10)SJ0850 | CABLE,POWER,ELECTRICAL.....                    | V          |
| 4                    | PAOZZ              | 4010-01-005-4775 | 81349        | M83420/3-001             | ROPE,WIRE .....                                | V          |
| END OF FIGURE        |                    |                  |              |                          |  |            |

THIS PAGE INTENTIONALLY LEFT BLANK

THIS PAGE INTENTIONALLY LEFT BLANK

---

ORGANIZATIONAL, DIRECT, AND GENERAL SUPPORT MAINTENANCE  
(INCLUDING DEPOT MAINTENANCE REPAIR)

CONTAINER, REFRIGERATED  
MODEL SC209, NSN: 8115-01-016-5909

SPECIAL TOOLS LIST

---

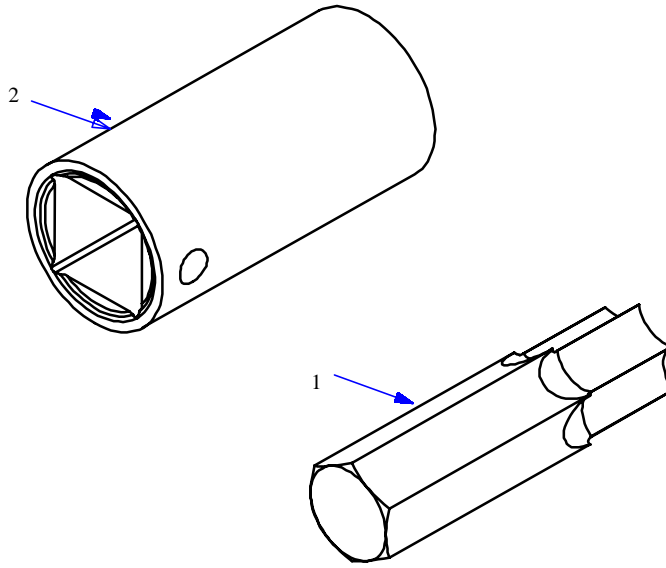

Figure 14. Special Tools

| (1)<br>Item<br>No | (2)<br>SMR<br>CODE | (3)<br>NSN       | (4)<br>CAGEC | (5)<br>PART NUMBER | (6)<br>DESCRIPTON AND USABLE ON<br>CODE (UOC) | (7)<br>QTY |
|-------------------|--------------------|------------------|--------------|--------------------|---|------------|
| 1                 | PA0ZZ              | 5120-01-091-3750 | 03705        | 80-TX55            | FIGURE 14 SPECIAL TOOLS<br>BIT, TORX.....     | 1          |
| 2                 | PAOZZ              | 5130-01-088-8833 | 03705        | TX-5416            | TOOL, DRIVE SOCKET.<br>END OF FIGURE          | 1          |

THIS PAGE INTENTIONALLY LEFT BLANK

**ORGANIZATIONAL, DIRECT, AND GENERAL SUPPORT MAINTENANCE  
(INCLUDING DEPOT MAINTENANCE REPAIR)**

**CONTAINER, REFRIGERATED  
MODEL SC209, NSN: 8115-01-016-5909**

**ELECTRICAL EQUIPMENT AND SPACERS**

**REPAIR PARTS LIST**

| <b>STOCK NUMBER</b> | <b>FIG.</b> | <b>ITEM</b> | <b>STOCK NUMBER</b> | <b>FIG.</b> | <b>ITEM</b> |
|---------------------|-------------|-------------|---------------------|-------------|-------------|
| 5310-00-014-5850    | 8           | 3           | 5305-00-782-4389    | 10          | 8           |
| 5310-00-045-3296    | 7           | 9A          | 5305-00-782-9494    | 13          | 5           |
| 5310-00-045-3296    | 8           | 2           | 5310-00-809-4058    | 13          | 12          |
| 5305-00-056-7879    | 9           | 33          | 5310-00-809-5997    | 13          | 4           |
| 5305-00-068-0501    | 13          | 10          | 5310-00-809-5998    | 12          | 3           |
| 5310-00-080-6004    | 2           | 9B          | 5310-00-809-8533    | 11          | 2           |
| 5310-00-080-6004    | 3           | 7B          | 5310-00-809-9998    | 4           | 4           |
| 5310-00-080-6004    | 7           | 3           | 5320-00-846-3852    | 1           | 19          |
| 5310-00-081-4219    | 13          | 15          | 5320-00-846-3852    | 2           | 21          |
| 5310-00-087-4652    | 2           | 9C          | 5320-00-846-3852    | 2           | 23          |
| 5310-00-087-4652    | 3           | 7C          | 5320-00-846-3852    | 3           | 14          |
| 5940-00-143-4774    | 9           | 26          | 5320-00-846-3852    | 3           | 16          |
| 5940-00-143-4794    | 13          | 7           | 5320-00-850-3264    | 2           | 11          |
| 5975-00-179-0098    | 9           | 18          | 5320-00-850-3264    | 3           | 9           |
| 5305-00-180-1991    | 9           | 9           | 5340-00-860-3862    | 1           | 10          |
| 5305-00-180-1991    | 9           | 13          | 5340-00-860-3862    | 1           | 20          |
| 5305-00-180-1991    | 9           | 16          | 5320-00-882-8385    | 13          | 1           |
| 5305-00-180-1991    | 10          | 2           | 5310-00-945-0528    | 2           | 14          |
| 5365-00-180-1991    | 10          | 4           | 5305-00-954-4295    | 13          | 9           |
| 6150-00-198-7395    | 9           | 4           | 5305-00-989-7435    | 7           | 8           |
| 5306-00-225-8501    | 13          | 13          | 2910-00-994-2536    | 7           | 11          |
| 5306-00-234-9731    | 8           | 5           | 4010-01-005-4775    | BULK        | 4           |
| 8040-00-262-9005    | 1           | 14          | 5975-01-106-6037    | 9           | 6           |
| 5305-00-269-3216    | 2           | 9A          | 6240-01-007-7637    | 9           | 3           |
| 5305-00-269-3216    | 3           | 7A          | 5340-01-051-9827    | 1           | 15          |
| 5305-00-269-3217    | 7           | 2           | 5340-01-051-9827    | 1           | 15          |
| 5340-00-290-4523    | 10          | 5           | 8115-01-066-6052    | 5           | 1           |
| 5975-00-296-1669    | 9           | 5           | 8115-01-066-6053    | 5           | 2           |
| 5975-00-497-5410    | 9           | 6           | 8115-01-066-6054    | 2           | 17          |
| 5310-00-550-1130    | 6           | 10          | 6685-01-072-0073    | 6           | 8           |
| 5310-00-582-5965    | 13          | 11          | 6685-01-072-0480    | 6           | 1           |
| 5310-00-584-7888    | 11          | 3           | 6680-01-072-2493    | 7           | 7           |
| 6145-00-617-1368    | BULK        | 3           | 2910-01-073-6023    | 7           | 10          |
| 5310-00-637-9541    | 7           | 4           | 5330-01-074-1355    | BULK        | 2           |
| 5315-00-682-2057    | 4           | 3           | 5330-01-074-1355    | 1           | 4           |
| 5940-00-682-2445    | 13          | 6           | 5320-01-074-1543    | 6           | 13          |
| 5340-00-689-7213    | 2           | 25          | 5365-01-074-1887    | 3           | 8           |
| 5340-00-689-7213    | 3           | 18          | 5365-01-074-1887    | 10          | 1           |
| 5340-00-733-7902    | 6           | 12          | 5365-01-074-1888    | 10          | 3           |
| 5310-00-761-6882    | 6           | 9           | 5365-01-074-1889    | 2           | 10          |
| 5310-00-763-8921    | 11          | 4           | 5330-01-074-1890    | 3           | 11          |

| STOCK NUMBER     | FIG. | ITEM | STOCK NUMBER     | FIG. | ITEM |
|------------------|------|------|------------------|------|------|
| 5330-01-074-1891 | 2    | 24   | 5310-01-270-1731 | 12   | 1    |
| 5330-01-074-1891 | 3    | 17   | 6115-01-275-5061 | 12   | 5    |
| 4010-01-074-2004 | 2    | 12   | 5305-01-325-8388 | 12   | 4    |
| 4010-01-074-2004 | 3    | 10   | 5310-01-335-4901 | 12   | 2    |
| 5330-01-074-3530 | 2    | 18   | 5310-01-338-7338 | 13   | 14   |
| 5330-01-074-3866 | 7    | 9    | 5340-01-480-2925 | 13   | 17   |
| 5310-01-077-1930 | 11   | 5    | 2990-01-480-9188 | 8    | 9    |
| 5310-01-079-6537 | 7    | 1    | 2990-01-480-9193 | 8    | 12   |
| 5130-01-088-8833 | 14   | 2    | 2990-01-480-9199 | 8    | 7    |
| 5120-01-091-3750 | 14   | 1    | 2990-01-480-9201 | 8    | 6    |
| 8115-01-204-3087 | 10   | 6    | 2990-01-480-9202 | 8    | 4    |
| 9540-01-206-4927 | 10   | 7    | 5305-01-481-3190 | 8    | 8    |
| 5306-01-244-8868 | 8    | 10   |                  |      |      |



**ORGANIZATIONAL, DIRECT, AND GENERAL SUPPORT MAINTENANCE  
(INCLUDING DEPOT MAINTENANCE REPAIR)**

**CONTAINER, REFRIGERATED  
MODEL SC209, NSN: 8115-01-016-5909**

**PART NUMBER INDEX**

| PART NUMBER          | FIG. | ITEM | PART NUMBER | FIG. | ITEM |
|----------------------|------|------|-------------|------|------|
| AD428SH              | 1    | 6    | MS27183-14  | 7    | 3    |
| AD42BSH              | 1    | 10   | MS27183-14  | 3    | 7B   |
| AD42BSH              | 1    | 11   | MS27183-14  | 2    | 9B   |
| AD42BSH              | 1    | 16   | MS27183-17  | 13   | 4    |
| AD44BS               | 3    | 14   | MS27183-18  | 4    | 4    |
| AD44BS               | 3    | 16   | MS27183-18  | 12   | 3    |
| AD44BS               | 1    | 19   | MS27183-23  | 11   | 2    |
| AD44BS               | 2    | 21   | MS27813-42  | 8    | 3    |
| AD44BS               | 2    | 23   | MS35190-287 | 13   | 9    |
| AD68BS               | 2    | 11   | MS35206-265 | 8    | 1    |
| AD68BS               | 3    | 9    | MS35207-264 | 7    | 8    |
| BU1062-1             | 2    | 2    | MS35333-40  | 6    | 10   |
| C005HLF-100750       | 9    | 30   | MS35338-43  | 8    | 2    |
| CD5601-00-0320       | 13   | 18   | MS35338-43  | 7    | 9A   |
| CO-O4HLF(4/10)SJ0850 | BULK | 3    | MS35338-44  | 13   | 11   |
| D217F31D2-DEG.DIV    | 6    | 7    | MS35338-45  | 13   | 14   |
| D6808-01             | 4    | 9    | MS35338-46  | 7    | 4    |
| D6808-02             | 4    | 10   | MS35338-48  | 12   | 2    |
| D6809-01             | 4    | 11   | MS35338-51  | 11   | 3    |
| D6809-02             | 4    | 8    | MS35493-74  | 9    | 33   |
| DGF38                | 7    | 11   | MS35493-78  | 9    | 13   |
| DL1104               | 3    | 5    | MS35493-78  | 9    | 16   |
| DL1104               | 2    | 7    | MS35493-78  | 10   | 2    |
| E942D                | 9    | 23   | MS35493-78  | 10   | 4    |
| E943D                | 9    | 22   | MS35493-78  | 9    | 9    |
| FE725-01-120         | 10   | 6    | MS51861-67  | 10   | 8    |
| FE8000-1             | 10   | 7    | MS51922-17  | 3    | 7C   |
| FIG343               | 9    | 11   | MS51922-17  | 2    | 9C   |
| H1060-4              | 3    | 2    | MS51967-14  | 12   | 1    |
| H1060-4              | 2    | 4    | MS51967-2   | 6    | 9    |
| HP1054-3             | 2    | 1    | MS51967-23  | 11   | 4    |
| M24243/6A-606H       | 13   | 1    | MS9048-104  | 4    | 3    |
| M83420/3-001         | BULK | 4    | MS90725-113 | 12   | 4    |
| MEP803A              | 12   | 5    | MS90725-114 | 13   | 5    |
| MILW5086-1-14        | 9    | 27   | MS90725-37  | 13   | 13   |
| MS25036-112          | 13   | 7    | MS90725-5   | 13   | 10   |
| MS25036-153          | 9    | 26   | MS90725-66  | 3    | 7A   |
| MS25036-158          | 13   | 6    | MS90725-66  | 2    | 9A   |
| MS27183-10           | 13   | 12   | MS90725-67  | 7    | 2    |
| MS27183-12           | 13   | 15   | MS9321-11   | 2    | 14   |

| PART NUMBER       | FIG. | ITEM | PART NUMBER  | FIG. | ITEM |
|-------------------|------|------|--------------|------|------|
| NS48143           | 10   | 5    | 30387-1      | 2    | 19   |
| RF3410            | 11   | 5    | 30388-1      | 3    | 13   |
| S256-002-A1A-83   | 6    | 4    | 30388-1      | 2    | 20   |
| S832-010-B1A-A2   | 6    | 2    | 30391-1      | 3    | 12   |
| SCD20648          | 1    | 10   | 30399-1      | 4    | 5    |
| SCD20648          | 1    | 20   | 30400-100    | 4    | 2    |
| SC-D-20650-14     | 1    | 15   | 30404-100    | 1    | 18   |
| SC-D-20650-14     | 1    | 5    | 30405-1      | 1    | 17   |
| SD42BSH           | 1    | 21   | 30405-100    | 1    | 12   |
| T99220-SS-120-576 | 13   | 3    | 30407-100    | 1    | 8    |
| TRDW-51           | 6    | 3    | 30408-1      | 1    | 7    |
| TT403             | 7    | 1    | 30408-100    | 1    | 3    |
| TX-5416           | 14   | 2    | 30410-1      | 9    | 19   |
| VC150             | 9    | 2    | 30411-1      | 9    | 12   |
| VG1               | 9    | 1    | 30413-100    | 4    | 6    |
| Y                 | 9    | 25   | 30414-100    | 4    | 7    |
| 1001              | 9    | 14   | 30416        | 6    | 1    |
| 100A              | 9    | 3    | 30436-100    | 3    | 10   |
| 1099              | 9    | 24   | 30436-100    | 2    | 12   |
| 1357              | 1    | 14   | 30438-1      | 10   | 1    |
| 151               | 9    | 10   | 30438-1      | 3    | 8    |
| 15-423            | 7    | 9    | 30438-2      | 10   | 3    |
| 17409             | 9    | 4    | 30438-3      | 2    | 10   |
| 1-8-3NA           | 6    | 12   | 30439-1      | 1    | 1    |
| 216               | 9    | 7    | 3043T18      | 8    | 10   |
| 217KLSP220-8      | 6    | 8    | 3043T32      | 8    | 5    |
| 22-250            | 8    | 6    | 30441-1      | 9    | 32   |
| 2303J013          | 7    | 11   | 30442-100    | 9    | 28   |
| 23535017          | 7    | 12   | 30447-1      | 5    | 1    |
| 245B-08X04        | 7    | 15   | 30447-2      | 5    | 2    |
| 250L              | 9    | 8    | 30448        | 5    | 3    |
| 2521              | 9    | 5    | 30449        | 5    | 4    |
| 260               | 9    | 15   | 30669-100    | 13   | 17   |
| 30301-100         | 4    | 1    | 30670-1      | 13   | 16   |
| 30302-21          | 9    | 21   | 30695-100    | 13   | 2    |
| 30302-25          | 9    | 20   | 30695-5      | 13   | 8    |
| 30305-100         | 7    | 10   | 30696-1      | 8    | 12   |
| 30306-1           | 7    | 5    | 30697-1      | 8    | 7    |
| 30307-1           | 7    | 6    | 30711-100    | 8    | 9    |
| 30355-100         | 2    | 16   | 30741-100    | 8    | 4    |
| 30356-100         | 2    | 15   | 30747-1      | 8    | 11   |
| 30356-101         | 2    | 17   | 38-104-09-93 | 1    | 2    |
| 30357-100         | 2    | 13   | 38-104-12-93 | 1    | 9    |
| 30373-1           | 2    | 22   | 38-106-12-91 | 6    | 13   |
| 30374-1           | 3    | 15   | 3885         | 6    | 11   |
| 30375-100         | 2    | 3    | 4111D1/8X2   | 1    | 13   |
| 30376-100         | 3    | 1    | 4111D1/8X2   | BULK | 1    |
| 30385-1           | 2    | 18   | 4111D1/8X3   | BULK | 2    |
| 30386-1           | 3    | 11   | 4111D1/8X3   | 1    | 4    |

---

| PART NUMBER    | FIG. | ITEM | PART NUMBER | FIG. | ITEM |
|----------------|------|------|-------------|------|------|
| 44605K117      | 8    | 13   |             |      |      |
| 50009801       | 6    | 5    |             |      |      |
| 5173-0         | 9    | 6    |             |      |      |
| 534FC          | 9    | 29   |             |      |      |
| 58R16-12       | 2    | 24   |             |      |      |
| 58R-16-12      | 3    | 17   |             |      |      |
| 64401703       | 6    | 6    |             |      |      |
| 6781-00236     | 7    | 7    |             |      |      |
| 7529296        | 3    | 18   |             |      |      |
| 7529296        | 2    | 25   |             |      |      |
| 80-TX55        | 14   | 1    |             |      |      |
| 821-82920      | 3    | 6A   |             |      |      |
| 821-82920      | 2    | 8A   |             |      |      |
| 821-84160      | 3    | 6    |             |      |      |
| 821-84160      | 2    | 5    |             |      |      |
| 821-84160      | 2    | 8    |             |      |      |
| 821-84160      | 3    | 3    |             |      |      |
| 830-FS-05      | 7    | 13   |             |      |      |
| 849FS-05X04    | 7    | 14   |             |      |      |
| 890-60008      | 3    | 4    |             |      |      |
| 890-60008      | 3    | 7    |             |      |      |
| 890-60008      | 2    | 9    |             |      |      |
| 890-60008      | 2    | 6    |             |      |      |
| 91324A430      | 8    | 8    |             |      |      |
| 91563A3-4-10X3 | 11   | 1    |             |      |      |
| 9587H61        | 9    | 31   |             |      |      |
| 95T050         | 9    | 17   |             |      |      |
| 96T050         | 9    | 18   |             |      |      |

THIS PAGE INTENTIONALLY LEFT BLANK

By Order of the Secretary of the Army:

Official:



JOEL B. HUDSON

*Administrative Assistant to the  
Secretary of the Army*

0335801

PETER J. SCHOOMAKER  
*General, United States Army*  
Chief of Staff

DISTRIBUTION:

To be distributed in accordance with Initial Distribution Number (IDN) 250497 requirements for TM 55-8115-202-24P.

THIS PAGE INTENTIONALLY LEFT BLANK

## ***These are the instructions for sending an electronic 2028***

The following format must be used if submitting an electronic 2028. The subject line must be exactly the same and all fields must be included; however only the following fields are mandatory: 1, 3, 4, 5, 6, 7, 8, 9, 10, 13, 15, 16, 17, and 27.

From: "Whomever" <whomever@avma27.army.mil>  
To: amssbriml@natick.army.mil

Subject: DA Form 2028

1. From: Joe Smith
2. Unit: home
3. Address: 4300 Park
4. City: Hometown
5. St: MO
6. Zip: 77777
7. Date Sent: 19-OCT-93
8. Pub no: 55-2840-229-23
9. Pub Title: TM
10. Publication Date: 04-JUL-85
11. Change Number: 7
12. Submitter Rank: MSG
13. Submitter FName: Joe
14. Submitter MName: T
15. Submitter LName: Smith
16. Submitter Phone: 123-123-1234
17. Problem: 1
18. Page: 2
19. Paragraph: 3
20. Line: 4
21. NSN: 5
22. Reference: 6
23. Figure: 7
24. Table: 8
25. Item: 9
26. Total: 123
27. Text:

This is the text for the problem below line 27.

THIS PAGE INTENTIONALLY LEFT BLANK



|  |          |            |            |  |           |  |       |
|--|----------|------------|------------|--|-----------|--|-------|
| <b>RECOMMENDED CHANGES TO PUBLICATIONS AND BLANK FORMS</b>   |          |            |            |  |           | Use Part II ( <i>reverse</i> ) for Repair Parts and Special Tool Lists (RPSTL) and Supply Catalogs/Supply Manuals (SC/SM). | DATE  |
| For use of this form, see AR 25-30; the proponent agency is ODISC4.  |          |            |            |  |           |  |       |
| TO: ( <i>Forward to proponent of publication or form</i> ) ( <i>Include ZIP Code</i> )<br>COMMANDER<br>U.S. ARMY TANK-AUTOMOTIVE AND ARMAMENT COMMAND<br>ATTN: AMSTA-LC-CECT<br>KANSAS STREET<br>NATICK, MA 01760-5052 |          |            |            |  |           | FROM: ( <i>Activity and location</i> ) ( <i>Include ZIP Code</i> )   |       |
| <b>PART I – ALL PUBLICATIONS (EXCEPT RPSTL AND SC/SM) AND BLANK FORMS</b>  |          |            |            |  |           |  |       |
| PUBLICATION/FORM NUMBER  |          |            |            |  |           | DATE   | TITLE |
| ITEM NO.   | PAGE NO. | PARA-GRAPH | LINE NO. * | FIGURE NO.                                 | TABLE NO. | RECOMMENDED CHANGES AND REASON<br><i>(Provide exact wording of recommended changes, if possible).</i>                      |       |
|  |          |            |            |  |           |  |       |
| <i>*Reference to line numbers within the paragraph or subparagraph.</i>  |          |            |            |  |           |  |       |
| TYPED NAME, GRADE OR TITLE   |          |            |            | TELEPHONE EXCHANGE/AUTOVON, PLUS EXTENSION |           | SIGNATURE  |       |

|  |  |             |
|--|--|-------------|
| <b>TO:</b> <i>(Forward direct to addressee listed in publication)</i><br>COMMANDER<br>U.S. ARMY TANK-AUTOMOTIVE AND ARMAMENT<br>COMMAND<br>ATTN: AMSTA-LC-CECT<br>KANSAS STREET<br>NATICK, MA 01760-5052 | <b>FROM:</b> <i>(Activity and location) (Include ZIP Code)</i> | <b>DATE</b> |
|--|--|-------------|

**PART II - REPAIR PARTS AND SPECIAL TOOL LISTS AND SUPPLY CATALOGS/SUPPLY MANUALS**

|   |                                     |  |
|---|-------------------------------------|--|
| <b>PUBLICATION NUMBER</b><br><br>TM 55-8115-202-24P | <b>DATE</b><br><br>31 DECEMBER 2003 | <b>TITLE</b><br>UNIT, DIRECT AND GENERAL SUPPORT<br>(INCLUDING DEPOT MAINTENANCE REPAIR)<br>REPAIR PARTS AND SPECIAL TOOLS LIST FOR<br>CONTAINER, REFRIGERATED MODEL SC209 |
|---|-------------------------------------|--|

| PAGE NO. | COLM NO. | LINE NO. | NATIONAL STOCK NUMBER | REFERENCE NO. | FIGURE NO. | ITEM NO. | TOTAL NO. OF MAJOR ITEMS SUPPORTED | RECOMMENDED ACTION |
|----------|----------|----------|-----------------------|---------------|------------|----------|------------------------------------|--------------------|
|          |          |          |                       |               |            |          |                                    |                    |

**PART III - REMARKS** *(Any general remarks or recommendations, or suggestions for improvement of publications and blank forms. Additional blank sheets may be used if more space is needed.)*

|                            |  |           |
|----------------------------|--|-----------|
| TYPED NAME, GRADE OR TITLE | TELEPHONE EXCHANGE/AUTOVON, PLUS EXTENSION | SIGNATURE |
|----------------------------|--|-----------|

|  |          |            |            |  |           |  |       |
|--|----------|------------|------------|--|-----------|--|-------|
| <b>RECOMMENDED CHANGES TO PUBLICATIONS AND BLANK FORMS</b>   |          |            |            |  |           | Use Part II ( <i>reverse</i> ) for Repair Parts and Special Tool Lists (RPSTL) and Supply Catalogs/Supply Manuals (SC/SM). | DATE  |
| For use of this form, see AR 25-30; the proponent agency is ODISC4.  |          |            |            |  |           |  |       |
| TO: ( <i>Forward to proponent of publication or form</i> ) ( <i>Include ZIP Code</i> )<br>COMMANDER<br>U.S. ARMY TANK-AUTOMOTIVE AND ARMAMENT COMMAND<br>ATTN: AMSTA-LC-CECT<br>KANSAS STREET<br>NATICK, MA 01760-5052 |          |            |            |  |           | FROM: ( <i>Activity and location</i> ) ( <i>Include ZIP Code</i> )   |       |
| <b>PART I – ALL PUBLICATIONS (EXCEPT RPSTL AND SC/SM) AND BLANK FORMS</b>  |          |            |            |  |           |  |       |
| PUBLICATION/FORM NUMBER  |          |            |            |  |           | DATE   | TITLE |
| ITEM NO.   | PAGE NO. | PARA-GRAPH | LINE NO. * | FIGURE NO.                                 | TABLE NO. | RECOMMENDED CHANGES AND REASON<br><i>(Provide exact wording of recommended changes, if possible).</i>                      |       |
|  |          |            |            |  |           |  |       |
| <i>*Reference to line numbers within the paragraph or subparagraph.</i>  |          |            |            |  |           |  |       |
| TYPED NAME, GRADE OR TITLE   |          |            |            | TELEPHONE EXCHANGE/AUTOVON, PLUS EXTENSION |           | SIGNATURE  |       |

|  |  |             |
|--|--|-------------|
| <b>TO:</b> <i>(Forward direct to addressee listed in publication)</i><br>COMMANDER<br>U.S. ARMY TANK-AUTOMOTIVE AND ARMAMENT<br>COMMAND<br>ATTN: AMSTA-LC-CECT<br>KANSAS STREET<br>NATICK, MA 01760-5052 | <b>FROM:</b> <i>(Activity and location) (Include ZIP Code)</i> | <b>DATE</b> |
|--|--|-------------|

**PART II - REPAIR PARTS AND SPECIAL TOOL LISTS AND SUPPLY CATALOGS/SUPPLY MANUALS**

|   |                                     |  |
|---|-------------------------------------|--|
| <b>PUBLICATION NUMBER</b><br><br>TM 55-8115-202-24P | <b>DATE</b><br><br>31 DECEMBER 2003 | <b>TITLE</b><br>UNIT, DIRECT AND GENERAL SUPPORT<br>(INCLUDING DEPOT MAINTENANCE REPAIR)<br>REPAIR PARTS AND SPECIAL TOOLS LIST FOR<br>CONTAINER, REFRIGERATED MODEL SC209 |
|---|-------------------------------------|--|

| PAGE NO. | COLM NO. | LINE NO. | NATIONAL STOCK NUMBER | REFERENCE NO. | FIGURE NO. | ITEM NO. | TOTAL NO. OF MAJOR ITEMS SUPPORTED | RECOMMENDED ACTION |
|----------|----------|----------|-----------------------|---------------|------------|----------|------------------------------------|--------------------|
|          |          |          |                       |               |            |          |                                    |                    |

**PART III - REMARKS** *(Any general remarks or recommendations, or suggestions for improvement of publications and blank forms. Additional blank sheets may be used if more space is needed.)*

|                                   |   |                  |
|-----------------------------------|---|------------------|
| <b>TYPED NAME, GRADE OR TITLE</b> | <b>TELEPHONE EXCHANGE/AUTOVON, PLUS EXTENSION</b> | <b>SIGNATURE</b> |
|-----------------------------------|---|------------------|

| <b>RECOMMENDED CHANGES TO PUBLICATIONS AND BLANK FORMS</b><br>For use of this form, see AR 25-30; the proponent agency is ODISC4.   |          |            |            |  |           | Use Part II ( <i>reverse</i> ) for Repair Parts and Special Tool Lists (RPSTL) and Supply Catalogs/Supply Manuals (SC/SM). | DATE  |
|---|----------|------------|------------|--|-----------|--|-------|
| <b>TO:</b> ( <i>Forward to proponent of publication or form</i> ) ( <i>Include ZIP Code</i> )<br>COMMANDER<br>U.S. ARMY TANK-AUTOMOTIVE AND ARMAMENT COMMAND<br>ATTN: AMSTA-LC-CECT<br>KANSAS STREET<br>NATICK, MA 01760-5052 |          |            |            |  |           | <b>FROM:</b> ( <i>Activity and location</i> ) ( <i>Include ZIP Code</i> )  |       |
| <b>PART I – ALL PUBLICATIONS (EXCEPT RPSTL AND SC/SM) AND BLANK FORMS</b>   |          |            |            |  |           |  |       |
| PUBLICATION/FORM NUMBER   |          |            |            |  |           | DATE   | TITLE |
| ITEM NO.  | PAGE NO. | PARA-GRAPH | LINE NO. * | FIGURE NO.                                 | TABLE NO. | RECOMMENDED CHANGES AND REASON<br><i>(Provide exact wording of recommended changes, if possible).</i>                      |       |
|   |          |            |            |  |           |  |       |
| <i>*Reference to line numbers within the paragraph or subparagraph.</i>   |          |            |            |  |           |  |       |
| TYPED NAME, GRADE OR TITLE  |          |            |            | TELEPHONE EXCHANGE/AUTOVON, PLUS EXTENSION |           | SIGNATURE  |       |

|  |  |             |
|--|--|-------------|
| <b>TO:</b> <i>(Forward direct to addressee listed in publication)</i><br>COMMANDER<br>U.S. ARMY TANK-AUTOMOTIVE AND ARMAMENT<br>COMMAND<br>ATTN: AMSTA-LC-CECT<br>KANSAS STREET<br>NATICK, MA 01760-5052 | <b>FROM:</b> <i>(Activity and location) (Include ZIP Code)</i> | <b>DATE</b> |
|--|--|-------------|

**PART II - REPAIR PARTS AND SPECIAL TOOL LISTS AND SUPPLY CATALOGS/SUPPLY MANUALS**

|   |                                     |  |
|---|-------------------------------------|--|
| <b>PUBLICATION NUMBER</b><br><br>TM 55-8115-202-24P | <b>DATE</b><br><br>31 DECEMBER 2003 | <b>TITLE</b><br>UNIT, DIRECT AND GENERAL SUPPORT<br>(INCLUDING DEPOT MAINTENANCE REPAIR)<br>REPAIR PARTS AND SPECIAL TOOLS LIST FOR<br>CONTAINER, REFRIGERATED MODEL SC209 |
|---|-------------------------------------|--|

| PAGE NO. | COLM NO. | LINE NO. | NATIONAL STOCK NUMBER | REFERENCE NO. | FIGURE NO. | ITEM NO. | TOTAL NO. OF MAJOR ITEMS SUPPORTED | RECOMMENDED ACTION |
|----------|----------|----------|-----------------------|---------------|------------|----------|------------------------------------|--------------------|
|          |          |          |                       |               |            |          |                                    |                    |

**PART III - REMARKS** *(Any general remarks or recommendations, or suggestions for improvement of publications and blank forms. Additional blank sheets may be used if more space is needed.)*

|                                   |   |                  |
|-----------------------------------|---|------------------|
| <b>TYPED NAME, GRADE OR TITLE</b> | <b>TELEPHONE EXCHANGE/AUTOVON, PLUS EXTENSION</b> | <b>SIGNATURE</b> |
|-----------------------------------|---|------------------|

## The Metric System and Equivalents

### *Linear Measure*

1 centimeter = 10 millimeters = .39 inch  
 1 decimeter = 10 centimeters = 3.94 inches  
 1 meter = 10 decimeters = 39.37 inches  
 1 dekameter = 10 meters = 32.8 feet  
 1 hectometer = 10 dekameters = 328.08 feet  
 1 kilometer = 10 hectometers = 3,280.8 feet

### *Weights*

1 centigram = 10 milligrams = .15 grain  
 1 decigram = 10 centigrams = 1.54 grains  
 1 gram = 10 decigrams = .035 ounce  
 1 dekagram = 10 grams = .35 ounce  
 1 hectogram = 10 dekagrams = 3.52 ounces  
 1 kilogram = 10 hectograms = 2.2 pounds  
 1 quintal = 100 kilograms = 220.46 pounds  
 1 metric ton = 10 quintals = 1.1 short tons

### *Liquid Measure*

1 centiliter = 10 milliliters = .34 fl. ounce  
 1 deciliter = 10 centiliters = 3.38 fl. ounces  
 1 liter = 10 deciliters = 33.81 fl. ounces  
 1 dekaliter = 10 liters = 2.64 gallons  
 1 hectoliter = 10 dekaliters = 26.42 gallons  
 1 kiloliter = 10 hectoliters = 264.18 gallons

### *Square Measure*

1 sq. centimeter = 100 sq. millimeters = .155 sq. inch  
 1 sq. decimeter = 100 sq. centimeters = 15.5 sq. inches  
 1 sq. meter (centare) = 100 sq. decimeters = 10.76 sq. feet  
 1 sq. dekameter (are) = 100 sq. meters = 1,076.4 sq. feet  
 1 sq. hectometer (hectare) = 100 sq. dekameters = 2.47 acres  
 1 sq. kilometer = 100 sq. hectometers = .386 sq. mile

### *Cubic Measure*

1 cu. centimeter = 1000 cu. millimeters = .06 cu. inch  
 1 cu. decimeter = 1000 cu. centimeters = 61.02 cu. inches  
 1 cu. meter = 1000 cu. decimeters = 35.31 feet

## Approximate Conversion Factors

| <i>To change</i> | <i>To</i>          | <i>Multiply by</i> | <i>To change</i>   | <i>To</i>     | <i>Multiply by</i> |
|------------------|--------------------|--------------------|--------------------|---------------|--------------------|
| inches           | centimeters        | 2.540              | ounce-inches       | newton-meters | .007062            |
| feet             | meters             | .305               | centimeters        | inches        | .394               |
| yards            | meters             | .914               | meters             | feet          | 3.280              |
| miles            | kilometers         | 1.609              | meters             | yards         | 1.094              |
| square inches    | square centimeters | 6.451              | kilometers         | miles         | .621               |
| square feet      | square meters      | .093               | square centimeters | square inches | .155               |
| square yards     | square meters      | .836               | square meters      | square feet   | 10.764             |
| square miles     | square kilometers  | 2.590              | square meters      | square yards  | 1.196              |
| acres            | square hectometers | .405               | square kilometers  | square miles  | .386               |
| cubic feet       | cubic meters       | .028               | square hectometers | acres         | 2.471              |
| cubic yards      | cubic meters       | .765               | cubic meters       | cubic feet    | 35.315             |
| fluid ounces     | milliliters        | 29.573             | cubic meters       | cubic yards   | 1.308              |
| pints            | liters             | .473               | milliliters        | fluid ounces  | .034               |
| quarts           | liters             | .946               | liters             | pints         | 2.113              |
| gallons          | liters             | 3.785              | liters             | quarts        | 1.057              |
| ounces           | grams              | 28.349             | liters             | gallons       | .264               |
| pounds           | kilograms          | .454               | grams              | ounces        | .035               |
| short tons       | metric tons        | .907               | kilograms          | pounds        | 2.205              |
| pound-feet       | newton-meters      | 1.356              | metric tons        | short tons    | 1.102              |
| pound-inches     | newton-meters      | .11296             |                    |               |                    |

## Temperature (Exact)

|    |                           |                               |                        |    |
|----|---------------------------|-------------------------------|------------------------|----|
| _F | Fahrenheit<br>temperature | 5/9 (after<br>subtracting 32) | Celsius<br>temperature | _C |
|----|---------------------------|-------------------------------|------------------------|----|

**043581-000**